



# Asbestos Reassessment

St. Michael  
135 Hester Street, Hamilton,  
Ontario

Prepared for:

**Hamilton-Wentworth Catholic  
District School Board**

90 Mulberry Street  
Hamilton, Ontario, L8N 3R9

May 15, 2023

Pinchin File: 320582.001



**Asbestos Reassessment**

St. Michael, 135 Hester Street, Hamilton, Ontario  
Hamilton-Wentworth Catholic District School Board

May 15, 2023  
Pinchin File: 320582.001

**Issued to:** Hamilton-Wentworth Catholic District  
School Board  
**Issued on:** May 15, 2023  
**Pinchin File:** 320582.001  
**Issuing Office:** Hamilton, ON



Hamilton-Wentworth  
Catholic District School Board  
*Believing. Achieving. Serving*

---

Author: Emily Balfour  
Project Manager  
365.889.5147  
[ebalfour@pinchin.com](mailto:ebalfour@pinchin.com)

---

Reviewer: Leslie Heywood, BEng Mgt  
Senior Project Manager  
289.237.4294  
[lheywood@pinchin.com](mailto:lheywood@pinchin.com)



## **EXECUTIVE SUMMARY**

Hamilton-Wentworth Catholic District School Board (Client) retained Pinchin Ltd. (Pinchin) to conduct an asbestos building materials reassessment at the subject building.

The objective of the reassessment was to evaluate the condition and quantity of previously reported asbestos-containing materials (ACM) and develop corrective action plans as required for the purposes of long-term management. The results of this reassessment are not intended for construction, renovation, demolition or project tendering purposes.

### **Summary of Recommendations**

The following is a summary of significant recommendations; refer to the body of the report for detailed recommendations:

- Perform a reassessment of asbestos-containing materials on an annual basis.
- Perform a pre-construction assessment and remove all asbestos-containing materials (ACM) prior to alteration or maintenance work if ACM may be disturbed by the work.
- Follow appropriate safe work procedures when handling or disturbing asbestos.
- Sample any presumed ACM prior to alteration or maintenance work if presumed ACM may be disturbed by the work.

*This Executive Summary is subject to the same standard limitations as contained in the report and must be read in conjunction with the entire report.*



## TABLE OF CONTENTS

1.0	INTRODUCTION AND SCOPE .....	1
1.1	Scope of Assessment and Methodology .....	1
2.0	BACKGROUND INFORMATION .....	1
2.1	Building Year of Construction and Additions .....	1
2.2	Existing Reports.....	1
3.0	FINDINGS .....	2
3.1	Excluded Asbestos Materials .....	2
3.2	Summary of Building Materials.....	3
4.0	RECOMMENDATIONS.....	8
4.1	General .....	8
4.2	Remedial Work .....	8
4.3	On-going Management and Maintenance .....	9
5.0	TERMS AND LIMITATIONS .....	9
6.0	REFERENCES.....	9

## APPENDICES

APPENDIX I	Asbestos Analytical Certificates
APPENDIX II	Location List
APPENDIX III	Hazardous Materials Summary / Sample Log Report
APPENDIX IV	All Data Report
APPENDIX V	Drawings
APPENDIX VI	Methodology



## 1.0 INTRODUCTION AND SCOPE

Hamilton-Wentworth Catholic District School Board (Client) retained Pinchin Ltd. (Pinchin) to conduct an asbestos building materials reassessment at St. Michael, located at 135 Hester Street, Hamilton, Ontario.

The reassessment was performed on March 29, 2023.

The objectives of the reassessment were to document the locations, quantities and conditions of previously identified asbestos-containing building materials and develop corrective action plans as required. This reassessment is only to be used for the purposes of long-term management and routine maintenance. The results of this reassessment are not to be used for construction, renovation, demolition or project tendering purposes.

### 1.1 Scope of Assessment and Methodology

The objective of the reassessment was to evaluate the condition and quantity of previously reported asbestos-containing materials (ACM) and develop corrective action plans as required.

Pinchin conducted a review of previously identified asbestos-containing materials (ACM) to evaluate the current condition of all accessible ACMs identified in the most recent assessment.

As per the original scope of work, concealed locations such as ceiling spaces above solid ceilings, shafts and chases were accessed via existing access panels. Our investigation did not include demolition of drywall or plaster walls to view concealed conditions. Structural items or exterior building finishes were not removed to determine the presence of concealed materials.

For further details on the methodology including test methods, refer to Appendix VI.

## 2.0 BACKGROUND INFORMATION

### 2.1 Building Year of Construction and Additions

Item	Details
Year of Construction	1966
Year(s) of Additions	2005

### 2.2 Existing Reports

#### 2.2.1 Review of Previous Reports

Pinchin previously prepared the following report, which has been reviewed and relied upon as part of this assessment:



## Asbestos Reassessment

St. Michael, 135 Hester Street, Hamilton, Ontario  
Hamilton-Wentworth Catholic District School Board

May 15, 2023

Pinchin File: 320582.001

- Asbestos Reassessment Report, St. Michael, 135 Hester Street, Hamilton, Ontario, August 2022, Prepared by Pinchin Ltd., Pinchin File: 303992.004.

### 3.0 FINDINGS

The following section summarizes the findings of the reassessment and provides a general description of the asbestos materials identified. The previously identified ACMs were observed to be in good condition

Previous analytical sample results have been relied upon and were included in the original asbestos assessment report completed by MTE Consultants Inc. Additional sample results where collected by Pinchin have been included in Appendix I.

#### 3.1 Excluded Asbestos Materials

A number of materials which might contain asbestos were not sampled during this reassessment due to limitations in scope and methodology. Where present, these materials are assumed to contain asbestos until otherwise proven by sampling and analysis. These materials are not shown on the drawings in Appendix V. Excluded materials presumed to contain asbestos include:

- Roofing felts and tar, mastics
- Floor levelling compound
- Ceramic tile setting compound
- Electrical components
- Mechanical packing, ropes and gaskets
- Vermiculite
- Adhesives and duct mastics
- Caulking and putties
- Fibre-reinforced paints and coatings
- Paper products
- Fire resistant doors
- Stucco, plaster or other cementitious parge coatings
- Vibration dampers on HVAC equipment
- Ropes and gaskets in cast-iron bell and spigot joints
- Sealants on pipe threads
- Terrazzo (where not sampled)

### 3.2 Summary of Building Materials



This section includes a summary of materials that have been confirmed asbestos-containing by sample analysis, presumed asbestos-containing by visual identification, or confirmed non-asbestos by sampling or based on the manufacture date and known end of use of asbestos in these products.



The locations of samples from the previous assessments performed by Pinchin have been included on the drawings in Appendix V.



Material and Application	Asbestos Type	Photo
Parging cement is present on pipe fittings (elbows, valves, tees, hangers etc.)	Chrysotile	
Sweatwrap insulation (brown layered paper), is present on straight sections of pipes.	None Detected	
Remaining pipes are either uninsulated or insulated with non-asbestos fibreglass or elastomeric insulation (Armaflex).	None	
Ducts are either uninsulated or insulated with non-asbestos fibreglass (foil-faced or canvas).	None	
Mechanical equipment is either uninsulated or insulated with non-asbestos fibreglass.	None	

Material and Application	Asbestos Type	Photo
<p>All ceiling tiles are determined to be non-asbestos based on previous sampling, the material (gypsum) or presumed to be non-asbestos based on the date of manufacture determined from the date stamp applied to the top of the tiles or the age of the materials determined from the age of the building addition.</p>	<p>None</p>	
<p>Textured plaster is present as an exterior soffit finish.</p>	<p>Chrysotile</p>	
<p>Smooth plaster present on walls and ceilings does not contain asbestos.</p>	<p>None Detected</p>	
<p>Non-asbestos drywall joint compound is present on wall and ceiling finishes.</p>	<p>None Detected</p>	

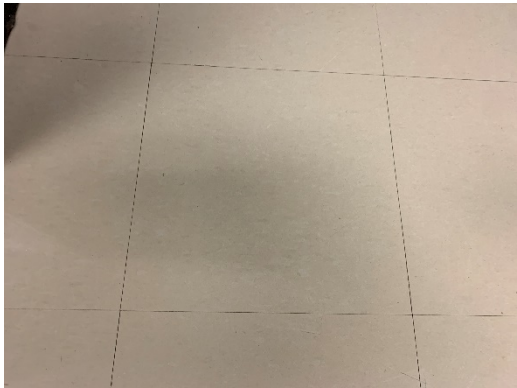

Material and Application	Asbestos Type	Photo
<p>Asbestos in drywall joint compound was banned in Canada in 1980. Drywall joint compound in the 2005 addition was installed after 1986 (1980 plus a reasonable non-compliance period based on our experience) and is assumed to contain no asbestos.</p>	<p>None</p>	
<p>Vinyl sheet flooring, with an off-white with dark flecks pattern is present under filing cabinets.</p>	<p>Presumed</p>	
<p>Vinyl floor tiles, 12"x12", mint with grey fleck, are present.</p>	<p>Presumed (tile) Presumed (mastic)</p>	
<p>Vinyl floor tiles, 12"x12", beige with orange flecks, are present.</p>	<p>Presumed (tile) Presumed (mastic)</p>	

Material and Application	Asbestos Type	Photo
<p>Vinyl floor tiles, 12"x12", salmon with white flecks, are present.</p>	<p>Presumed (tile) Presumed (mastic)</p>	
<p>Vinyl floor tiles, 12"x12", salmon with brown streaks, are present.</p>	<p>Presumed (tile) Presumed (mastic)</p>	
<p>Vinyl floor tiles, 12"x12", beige with yellow flecks, are present.</p>	<p>Presumed (tile) Presumed (mastic)</p>	

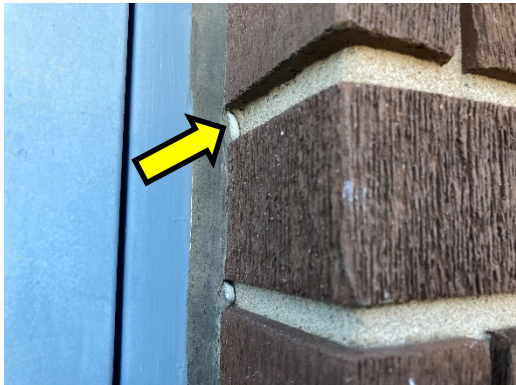
Material and Application	Asbestos Type	Photo
<p>Vinyl floor tiles, 12"x12", tan with brown streaks, are present.</p>	<p>Presumed (tile) Presumed (mastic)</p>	
<p>Remaining vinyl floor tiles were presumed to be non-asbestos based on historical knowledge of the date of installation.</p> <p>Mastic underneath new vinyl floor tiles (excluding the 2005 addition) is presumed to contain asbestos until sampling proves otherwise.</p>	<p>None (tile) Presumed (mastic)</p>	
<p>Pipe packing material is present in an exterior bell and spigot fitting.</p>	<p>Amosite and Chrysotile</p>	
<p>White caulking is present under new non-asbestos caulking around an exterior door.</p>	<p>Chrysotile</p>	



## Asbestos Reassessment

St. Michael, 135 Hester Street, Hamilton, Ontario  
Hamilton-Wentworth Catholic District School Board

May 15, 2023

Pinchin File: 320582.001

Material and Application	Asbestos Type	Photo
Non-asbestos caulking is present on the exterior of the building around window frames, door frames, and expansion joints.	None Detected	
Loose fill vermiculite was not observed within exterior masonry block walls while performing destructive testing. Penetrations were created in 6 locations; the locations of destructive testing have been indicated on the drawings in Appendix V.	None Found If found, vermiculite is presumed to contain asbestos until further sampling proves otherwise.	
Terrazzo is present on floors in the Stairwells.	<0.5% Chrysotile (non-asbestos as per O. Reg 278/05)	

Additional notes on the drywall joint compound discussed above:

- Drywall (gypsum board) and drywall joint compound is present as a wall and ceiling finish in limited locations within the original section of the building. As per the methodology, drywall joint compound is sampled at exterior walls, columns or other locations that are unlikely to have been renovated in an attempt to determine the presence of asbestos in the original drywall compound. A total of 3 samples of drywall joint compound were collected (samples S0003A-C, lab reference no. 71919978) and it was found that all samples do not contain asbestos. Therefore, drywall joint compound present on drywall finishes should be considered to be non-asbestos.

## 4.0 RECOMMENDATIONS

### 4.1 General

Perform a detailed intrusive assessment prior to building renovation or demolition operations. The assessment should include; destructive testing (i.e. coring and/or removal of building finishes and components), sampling of other hazardous materials (lead, mercury, PCBs, mould, etc.), and materials not tested in this study (i.e. excluded asbestos materials).

### 4.2 Remedial Work

There is no remedial work recommended.



### **4.3 On-going Management and Maintenance**

The following recommendations are made regarding on-going management and maintenance work involving the asbestos materials identified.

#### **4.3.1 Asbestos**

Maintain the Asbestos Management Program (AMP).

Perform a reassessment of asbestos materials on an annual basis.

Remove asbestos-containing materials (ACM) prior to alteration or maintenance work if ACM may be disturbed by the work. Follow appropriate asbestos precautions for the classification of work being performed.

Sample presumed ACM prior to alteration or maintenance work if the presumed ACM may be disturbed by the work.

Update the asbestos inventory report upon completion of any abatement and removal of asbestos-containing materials.

### **5.0 TERMS AND LIMITATIONS**

This work was performed subject to the Terms and Limitations presented or referenced in the proposal for this project.

Information provided by Pinchin is intended for Client use only. Pinchin will not provide results or information to any party unless disclosure by Pinchin is required by law. Any use by a third party of reports or documents authored by Pinchin or any reliance by a third party on or decisions made by a third party based on the findings described in said documents, is the sole responsibility of such third parties. Pinchin accepts no responsibility for damages suffered by any third party as a result of decisions made or actions conducted. No other warranties are implied or expressed.

### **6.0 REFERENCES**

The following legislation and documents were referenced in completing the assessment and this report:

1. Asbestos on Construction Projects and in Buildings and Repair Operations, Ontario Regulation 278/05.
2. Designated Substances, Ontario Regulation 490/09.

\\PIN-HAM-FS02\job\320000s\0320582.000 HWCDSB, Various2023Projects, ASB, CONS\0320582.001 HWCDSB, Various, ReportUpdates, ASB, REASSMT\Deliverables\Reassess\St. Michael\Report\320582.001 St. Michael ACM Reassessment Report HWCDSB May 15 2023.docx

Template: Master Report for Asbestos Reassessment, HAZ, April 23, 2019

**APPENDIX I**  
**Asbestos Analytical Certificates**



# Bulk Asbestos Analysis

By Polarized Light Microscopy  
 EPA Method: 600/R-93/116 and 40 CFR, Part 763, Subpart E,  
 App.E

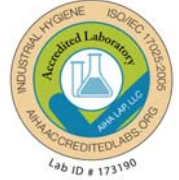

**Customer:** Pinchin Ltd.  
 6-875 Main St West  
 Suite 200  
 Hamilton, Ontario L8S 4P9

**Attn:** Emily Balfour  
 Michael Maiorana

**Lab Order ID:** 71919978  
**Analysis ID:** 71919978\_PLM  
**Date Received:** 7/30/2019  
**Date Reported:** 8/5/2019

**Project:** 230748,135 Hester St, Hamilton, ON,Hamilton-Wentworth Catholic School Board,St.  
 Michael Catholic Elementary School

Sample ID	Description	Asbestos	Fibrous Components	Non-Fibrous Components	Attributes
Lab Sample ID	Lab Notes				Treatment
S0001A	Textured Plaster, Soffit, Location 1007	1% Chrysotile		99% Other	White Non Fibrous Heterogeneous
71919978PLM_1					Crushed
S0001B	Textured Plaster, Soffit, Location 1007	Not Analyzed			
71919978PLM_2					
S0001C	Textured Plaster, Soffit, Location 1007	Not Analyzed			
71919978PLM_3					
S0002A - A	Smooth plaster on ceiling, Boy's Washroom, Location 1018	None Detected		100% Other	White Non Fibrous Heterogeneous
71919978PLM_4	finish				Crushed
S0002A - B	Smooth plaster on ceiling, Boy's Washroom, Location 1018	None Detected		100% Other	Tan Non Fibrous Heterogeneous
71919978PLM_14	base				Crushed
S0002B - A	Smooth plaster on wall, Kitchen, Location 1022	None Detected		100% Other	White Non Fibrous Heterogeneous
71919978PLM_5	finish				Crushed
S0002B - B	Smooth plaster on wall, Kitchen, Location 1022	None Detected		100% Other	Tan Non Fibrous Heterogeneous
71919978PLM_15	base				Crushed
S0002C - A	Smooth plaster on ceiling, Main Office, Location 1005	None Detected		100% Other	White Non Fibrous Heterogeneous
71919978PLM_6	finish				Crushed

**Disclaimer:** Due to the nature of the EPA 600 method, asbestos may not be detected in samples containing low levels of asbestos. We strongly recommend that analysis of floor tiles, vermiculite, and/or heterogeneous soil samples be conducted by TEM for confirmation of "None Detected" by PLM. This report relates only to the samples tested and may not be reproduced, except in full, without the written approval of SAL. This report may not be used by the client to claim product endorsement by NVLAP or any other agency of the U.S. government. Analytical uncertainty available upon request. Scientific Analytical Institute participates in the NVLAP Proficiency Testing program. Unless otherwise noted blank sample correction was not performed. Estimated MDL is 0.1%.

Charmel Dozier (20)

Analyst

Approved Signatory



# Bulk Asbestos Analysis

By Polarized Light Microscopy  
 EPA Method: 600/R-93/116 and 40 CFR, Part 763, Subpart E,  
 App.E



**Customer:** Pinchin Ltd.  
 6-875 Main St West  
 Suite 200  
 Hamilton, Ontario L8S 4P9

**Attn:** Emily Balfour  
 Michael Maiorana

**Lab Order ID:** 71919978  
**Analysis ID:** 71919978\_PLM  
**Date Received:** 7/30/2019  
**Date Reported:** 8/5/2019

**Project:** 230748,135 Hester St, Hamilton, ON,Hamilton-Wentworth Catholic School Board,St.  
 Michael Catholic Elementary School

Sample ID	Description	Asbestos	Fibrous Components	Non-Fibrous Components	Attributes
Lab Sample ID	Lab Notes				Treatment
S0002C - B	Smooth plaster on ceiling, Main Office, Location 1005	None Detected		100% Other	Tan Non Fibrous Heterogeneous
71919978PLM_16	base				Crushed
S0002D - A	Smooth plaster on ceiling, Classroom 2, Location 1015	None Detected		100% Other	White Non Fibrous Heterogeneous
71919978PLM_7	finish				Crushed
S0002D - B	Smooth plaster on ceiling, Classroom 2, Location 1015	None Detected		100% Other	Tan Non Fibrous Heterogeneous
71919978PLM_17	base				Crushed
S0002E - A	Smooth plaster on ceiling, Women's Staff Washroom, Location 2012	None Detected		100% Other	White Non Fibrous Heterogeneous
71919978PLM_8	finish				Crushed
S0002E - B	Smooth plaster on ceiling, Women's Staff Washroom, Location 2012	None Detected		100% Other	Tan Non Fibrous Heterogeneous
71919978PLM_18	base				Crushed
S0002F - A	Smooth plaster on wall above door, Stairwell, Location 2002	None Detected		100% Other	White Non Fibrous Heterogeneous
71919978PLM_9	finish				Crushed
S0002F - B	Smooth plaster on wall above door, Stairwell, Location 2002	None Detected		100% Other	Tan Non Fibrous Heterogeneous
71919978PLM_19	base				Crushed
S0002G - A	Smooth plaster on ceiling, Boy's Washroom, Location 2008	None Detected		100% Other	White Non Fibrous Heterogeneous
71919978PLM_10	finish				Crushed

**Disclaimer:** Due to the nature of the EPA 600 method, asbestos may not be detected in samples containing low levels of asbestos. We strongly recommend that analysis of floor tiles, vermiculite, and/or heterogeneous soil samples be conducted by TEM for confirmation of "None Detected" by PLM. This report relates only to the samples tested and may not be reproduced, except in full, without the written approval of SAL. This report may not be used by the client to claim product endorsement by NVLAP or any other agency of the U.S. government. Analytical uncertainty available upon request. Scientific Analytical Institute participates in the NVLAP Proficiency Testing program. Unless otherwise noted blank sample correction was not performed. Estimated MDL is 0.1%.

Charmel Dozier (20)

Analyst

Approved Signatory





# Bulk Asbestos Analysis

By Polarized Light Microscopy  
EPA Method: 600/R-93/116 and 40 CFR, Part 763, Subpart E,  
App.E

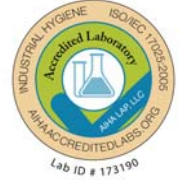

**Customer:** Pinchin Ltd.  
6-875 Main St West  
Suite 200  
Hamilton, Ontario L8S 4P9

**Attn:** Emily Balfour  
Michael Maiorana

**Lab Order ID:** 71919978  
**Analysis ID:** 71919978\_PLM  
**Date Received:** 7/30/2019  
**Date Reported:** 8/5/2019

**Project:** 230748,135 Hester St, Hamilton, ON,Hamilton-Wentworth Catholic School Board,St.  
Michael Catholic Elementary School

Sample ID	Description	Asbestos	Fibrous Components	Non-Fibrous Components	Attributes
Lab Sample ID	Lab Notes				Treatment
S0002G - B	Smooth plaster on ceiling, Boy's Washroom, Location 2008	None Detected		100% Other	Tan Non Fibrous Heterogeneous
71919978PLM_20	base				Crushed
S0003A	DJC on wall, Kitchen, Location 1022	None Detected		100% Other	White Non Fibrous Heterogeneous
71919978PLM_11					Crushed
S0003B	DJC on wall, Library, Location 1040	None Detected		100% Other	White Non Fibrous Heterogeneous
71919978PLM_12					Crushed
S0003C	DJC on column, Classroom 2, Location 1015	None Detected		100% Other	White Non Fibrous Heterogeneous
71919978PLM_13					Crushed

**Disclaimer:** Due to the nature of the EPA 600 method, asbestos may not be detected in samples containing low levels of asbestos. We strongly recommend that analysis of floor tiles, vermiculite, and/or heterogeneous soil samples be conducted by TEM for confirmation of "None Detected" by PLM. This report relates only to the samples tested and may not be reproduced, except in full, without the written approval of SAL. This report may not be used by the client to claim product endorsement by NVLAP or any other agency of the U.S. government. Analytical uncertainty available upon request. Scientific Analytical Institute participates in the NVLAP Proficiency Testing program. Unless otherwise noted blank sample correction was not performed. Estimated MDL is 0.1%.

Charmel Dozier (20)

Analyst

Approved Signatory

71919978

Version 1-15-2012

**Client:** Pinchin Ltd.  
**Contact:** Emily Balfour  
 6-875 Main Street West, Suite 200,  
 Hamilton ON L8S 4P9  
**Address:**  
**Phone:** 905-577-6206  
**Fax:** 905-577-6207  
**Email:** ebalfour@pinchin.com  
 mmaiorana@pinchin.com  
 230748, 135 Hester St, Hamilton,  
 ON, Hamilton-Wentworth Catholic  
 School Board, St. Michael Catholic  
 Elementary School  
**Project:**  
**Client Notes:**  
**P.O. #:** 230748  
**Date Submitted:** July 29, 2019  
**Analysis:** PLM - Stop Positive EXCEPT  
 S0003  
**TurnAroundTime:** 4days

**\*Instructions:**  
 Use Column "B" for your contact info  
  
 To See an Example Click the  
 bottom Example Tab.  
  
 Enter samples between "<<" and ">>"  
  
 Begin Samples with a "<<" above the first sample  
 and end with a ">>" below the last sample.  
 Only Enter your data on the first sheet "Sheet1"  
  
 Note: Data 1 and Data 2 are optional  
 fields that do not show up on the official  
 report, however they will be included  
  
 in the electronic data returned to you  
 to facilitate your reintegration of the report data.

**Invoice to:**  
 ap@pinchin.com  
  
  
**Scientific Analytical Institute**  
  
**4604 Dundas Dr.**  
**Greensboro, NC 27407**  
**Phone: 336.292.3888**  
  
**Fax: 336.292.3313**  
**Email: lab@sailab.com**

Sample Number	Data 1 (Lab use only)	Sample Description	Data 2 (Lab use only)
---------------	-----------------------	--------------------	-----------------------

<<			
S0001A		Textured Plaster, Soffit, Location 1007	
S0001B		Textured Plaster, Soffit, Location 1007	
S0001C		Textured Plaster, Soffit, Location 1007	
S0002A		Smooth plaster on ceiling, Boy's Washroom, Location 1018	
S0002B		Smooth plaster on wall, Kitchen, Location 1022	
S0002C		Smooth plaster on ceiling, Main Office, Location 1005	
S0002D		Smooth plaster on ceiling, Classroom 2, Location 1015	
S0002E		Smooth plaster on ceiling, Women's Staff Washroom, Location 2012	
S0002F		Smooth plaster on wall above door, Stairwell, Location 2002	
S0002G		Smooth plaster on ceiling, Boy's Washroom, Location 2008	
S0003A		DJC on wall, Kitchen, Location 1022	
S0003B		DJC on wall, Library, Location 1040	
S0003C		DJC on column, Classroom 2, Location 1015	
>>			

Accepted

Rejected

N. Francis 7/30 10:30A



## Pinchin Ltd. Asbestos Laboratory Certificate of Analysis

**Project Name:** Hamilton-Wentworth Catholic School Board,  
St. Michael Catholic Elementary School, 135 Hester St, Hamilton, ON

**Project No.:** 0272113.000

**Prepared For:** E. Balfour / M. Maiorana

**Lab Reference No.:** b230666

**Analyst(s):** K. Cockburn

**Date Received:** May 21, 2020

**Date Analyzed:** June 1, 2020

**# Samples submitted:** 6

**# Phases analyzed:** 7

### Method of Analysis:

#### **EPA 600/R-93/116 - Method for the Determination of Asbestos in Bulk Building Materials dated July, 1993**

Bulk samples are checked visually and scanned under a stereomicroscope. Slides are prepared and observed under a Polarized Light Microscope (PLM) at magnifications of 40X, 100X or 400X as appropriate. Asbestos fibres are identified by a combination of morphology, colour, refractive index, extinction, sign of elongation, birefringence and dispersion staining colours. A visual estimate is made of the percentage of asbestos present. A reported concentration of less than (<) the regulatory threshold (see chart below) indicates the presence of confirmed asbestos in trace quantities, limited to only a few fibres or fibre bundles in an entire sample. This method complies with provincial regulatory requirements where applicable. Multiple phases within a sample are analyzed and reported separately.

All bulk samples submitted to this laboratory for asbestos analysis are retained for a minimum of three months. Samples may be retrieved, upon request, for re-examination at any time during that period.

The Pinchin Ltd. Mississauga asbestos laboratory is accredited by the National Institute of Standards and Technology, National Voluntary Laboratory Accreditation Program (NVLAP Lab Code 101270-0) for the 'EPA – 40 CFR Appendix E to Subpart E of Part 763, Interim Method of the Determination of Asbestos in Bulk Insulation Samples,' and the 'EPA 600/R-93/116: Method for the Determination of Asbestos in Bulk Building Materials'; and meets all requirements of ISO/IEC 17025:2005.

This report relates only to the items tested.

**NOTE:** *This test report may not be reproduced, except in full, without the written approval of the laboratory. The client may not use this report to claim product endorsement by NVLAP or any agency of the U.S. Government. This report is valid only when signed in blue ink by the analyst. Vinyl asbestos floor tiles contain very fine fibres of asbestos and may be missed by some laboratories using the PLM method. Internal verification studies performed by Pinchin indicate that the chance of missing asbestos in floor tiles is no higher than about 2%. The vinyl tile study and laboratory documentation on measurement uncertainty is available upon request. The analysis of dust samples by PLM cannot be used as an indicator of past or present airborne asbestos fibre levels.*



## Pinchin Ltd. Asbestos Laboratory Certificate of Analysis

**Project Name:** Hamilton-Wentworth Catholic School Board,  
 St. Michael Catholic Elementary School, 135 Hester St, Hamilton, ON  
**Project No.:** 0272113.000  
**Prepared For:** E. Balfour / M. Maiorana  
  
**Lab Reference No.:** b230666  
**Date Analyzed:** June 1, 2020

### BULK SAMPLE ANALYSIS

SAMPLE IDENTIFICATION	SAMPLE DESCRIPTION	% COMPOSITION (VISUAL ESTIMATE)			
		ASBESTOS		OTHER	
S0004A Parging cement, Corridor, Location 1003	Homogeneous, grey, soft, parging cement.	Chrysotile	50-75%	Non-Fibrous Material	25-50%
S0004B Parging cement, Corridor, Location 1003				Not Analyzed	
Comments:	Analysis was stopped due to a previous positive result.				
S0004C Parging cement, Corridor, Location 1003				Not Analyzed	
Comments:	Analysis was stopped due to a previous positive result.				
S0005A Sweatwrap, Corridor, Location 2005	2 Phases: a) Homogeneous, beige, dimpled, layered paper.  b) Homogeneous, black, layered paper.	None Detected		Cellulose	> 75%
		None Detected		Non-Fibrous Material	0.5-5%
				Cellulose	50-75%
				Tar and other non-fibrous	25-50%
S0005B Sweatwrap, Corridor, Location 2005	2 Phases: a) Homogeneous, beige, dimpled, layered paper.  b) Homogeneous, black, layered paper.	None Detected		Cellulose	> 75%
		None Detected		Non-Fibrous Material	0.5-5%
				Cellulose	50-75%
				Tar and other non-fibrous	25-50%



**Pinchin Ltd. Asbestos Laboratory**  
***Certificate of Analysis***

**Project Name:** Hamilton-Wentworth Catholic School Board,  
St. Michael Catholic Elementary School, 135 Hester St, Hamilton, ON  
**Project No.:** 0272113.000  
**Prepared For:** E. Balfour / M. Maiorana  
**Lab Reference No.:** b230666  
**Date Analyzed:** June 1, 2020

**BULK SAMPLE ANALYSIS**

SAMPLE IDENTIFICATION	SAMPLE DESCRIPTION	% COMPOSITION (VISUAL ESTIMATE)	
		ASBESTOS	OTHER
S0005C Sweatwrap, Corridor, Location 2005	2 Phases: a) Homogeneous, beige, dimpled, layered paper.	None Detected	Cellulose > 75% Non-Fibrous Material 0.5-5%
	b) Homogeneous, black, layered paper.	None Detected	Cellulose 50-75% Tar and other non-fibrous 25-50%

**Reviewed by:**

**Reporting Analyst:**



Analyzed by: *[Signature]*  
 Reviewed by: *[Signature]*  
 Report Sent by: *[Signature]*



**Instructions:**

**Pinchin Ltd. - Asbestos Laboratory  
 Internal Asbestos Bulk Sample Chain of Custody**

<b>Client Name:</b>	Hamilton-Wentworth Catholic School Board	<b>Project Address:</b>	135 Hester St, Hamilton, ON
<b>Portfolio/Building No:</b>	St. Michael Catholic Elementary School	<b>Pinchin File:</b>	272113
<b>Submitted by:</b>	Emily Balfour	<b>Email:</b>	ebalfour@pinchin.com
<b>CC Results to:</b>	Michael Maiorana	<b>CC Email:</b>	mmaiorana@pinchin.com
<b>Invoice to:</b>	Accounts Payable	<b>Invoice Email:</b>	ap@pinchin.com
<b>Date Submitted:</b>	May 19 2020	<b>Required by:</b>	May 26 2020
<b># of Samples:</b>	6	<b>Priority:</b>	5 Day Turnaround
<b>Year of Building Construction (Mandatory Field):</b>	1966		
<b>Do NOT Stop on Positive (Sample Numbers):</b>			
<b>Pinchin Group Company (Mandatory Field):</b>	Pinchin		

**To be Completed by Lab Personnel Only:**

<b>Lab Reference #:</b>	<i>b230666 dk</i>	<b>Time:</b>	24 hour clock		
<b>Received by:</b>	<i>MAY 21 2020</i>	<b>Date:</b>	Month	Day	Year
<b>Name(s) of Analyst(s):</b>	<i>[Signature] 2020/06/01</i>				

Sample Prefix	Sample No.	Sample Suffix	Sample Description/Location (Mandatory)
	S0004	A	Parging cement, Corridor, Location 1003 <i>CH50-75?</i>
	S0004	B	Parging cement, Corridor, Location 1003 <i>- NA -</i>
	S0004	C	Parging cement, Corridor, Location 1003 <i>- NA -</i>
	S0005	A	Sweatwrap, Corridor, Location 2005 <i>a) ND b) ND</i>
	S0005	B	Sweatwrap, Corridor, Location 2005 <i>a) ND b) ND</i>
	S0005	C	Sweatwrap, Corridor, Location 2005 <i>a) ND b) ND</i>



# Bulk Asbestos Analysis

By Polarized Light Microscopy  
EPA Method: 600/R-93/116 and 40 CFR, Part 763, Subpart E,  
App.E



**Customer:** Pinchin Ltd.  
6-875 Main St West  
Suite 200  
Hamilton, Ontario L8S 4P9

**Attn:** Matt Pitman  
Emily Balfour

**Lab Order ID:** 71965751  
**Analysis ID:** 71965751\_PLM  
**Date Received:** 5/17/2021  
**Date Reported:** 5/19/2021

**Project:** HWCDSB 135 Hester Street, ON, Hamilton St. Michael Catholic School 286533.002

Sample ID	Description	Asbestos	Fibrous Components	Non-Fibrous Components	Attributes
Lab Sample ID	Lab Notes				Treatment
S0006A	Wall,Caulking,Brown Caulking,Loc:1041,Exterior - Old Section	None Detected		100% Other	Black Non Fibrous Homogeneous
71965751PLM_1					Ashed
S0006B	Wall,Caulking,Brown Caulking,Loc:1041,Exterior - Old Section	None Detected		100% Other	Black Non Fibrous Homogeneous
71965751PLM_2					Ashed
S0006C	Wall,Caulking,Brown Caulking,Loc:1041,Exterior - Old Section	None Detected		100% Other	Black Non Fibrous Homogeneous
71965751PLM_3					Ashed
S0007A	Wall,Caulking,Light Grey Caulking,Loc:1041,Exterior - Old Section	None Detected		100% Other	Gray Non Fibrous Homogeneous
71965751PLM_4					Ashed
S0007B	Wall,Caulking,Light Grey Caulking,Loc:1041,Exterior - Old Section	None Detected		100% Other	Gray Non Fibrous Homogeneous
71965751PLM_5					Ashed
S0007C	Wall,Caulking,Light Grey Caulking,Loc:1041,Exterior - Old Section	None Detected		100% Other	Gray Non Fibrous Homogeneous
71965751PLM_6					Ashed
S0008A	Wall,Caulking,Dark Grey Caulking,Loc:1041,Exterior - Old Section	None Detected		100% Other	Gray Non Fibrous Homogeneous
71965751PLM_7					Ashed
S0008B	Wall,Caulking,Dark Grey Caulking,Loc:1041,Exterior - Old Section	None Detected		100% Other	Gray Non Fibrous Homogeneous
71965751PLM_8					Ashed

Disclaimer: Due to the nature of the EPA 600 method, asbestos may not be detected in samples containing low levels of asbestos. We strongly recommend that analysis of floor tiles, vermiculite, and/or heterogeneous soil samples be conducted by TEM for confirmation of "None Detected" by PLM. This report relates only to the samples tested and may not be reproduced, except in full, without the written approval of SAL. This report may not be used by the client to claim product endorsement by NVLAP or any other agency of the U.S. government. Analytical uncertainty available upon request. Scientific Analytical Institute participates in the NVLAP Proficiency Testing program. Unless otherwise noted blank sample correction was not performed. Estimated MDL is 0.1%.

Yanelis Delgado (21)

Analyst

Approved Signatory



# Bulk Asbestos Analysis

By Polarized Light Microscopy  
 EPA Method: 600/R-93/116 and 40 CFR, Part 763, Subpart E,  
 App.E



**Customer:** Pinchin Ltd.  
 6-875 Main St West  
 Suite 200  
 Hamilton, Ontario L8S 4P9

**Attn:** Matt Pitman  
 Emily Balfour

**Lab Order ID:** 71965751  
**Analysis ID:** 71965751\_PLM  
**Date Received:** 5/17/2021  
**Date Reported:** 5/19/2021

**Project:** HWCDSB 135 Hester Street, ON, Hamilton St. Michael Catholic School 286533.002

Sample ID	Description	Asbestos	Fibrous Components	Non-Fibrous Components	Attributes
Lab Sample ID	Lab Notes				Treatment
S0008C	Wall,Caulking,Dark Grey Caulking,Loc:1041,Exterior - Old Section	None Detected		100% Other	Gray Non Fibrous Homogeneous
71965751PLM_9					Ashed
S0009A	Wall,Caulking,Beige Caulking,Loc:1041,Exterior - Old Section	None Detected		100% Other	Gray Non Fibrous Homogeneous
71965751PLM_10					Ashed
S0009B	Wall,Caulking,Beige Caulking,Loc:1041,Exterior - Old Section	None Detected		100% Other	Gray Non Fibrous Homogeneous
71965751PLM_11					Ashed
S0009C	Wall,Caulking,Beige Caulking,Loc:1041,Exterior - Old Section	None Detected		100% Other	Gray Non Fibrous Homogeneous
71965751PLM_12					Ashed
S0010A	Wall,Caulking,White Caulking,Loc:1041,Exterior - Old Section	5% Chrysotile		95% Other	White Non Fibrous Homogeneous
71965751PLM_13					Ashed
S0010B	Wall,Caulking,White Caulking,Loc:1041,Exterior - Old Section	Not Analyzed			
71965751PLM_14					
S0010C	Wall,Caulking,White Caulking,Loc:1041,Exterior - Old Section	Not Analyzed			
71965751PLM_15					
S0011A	Wall,Caulking,White Caulking,Loc:1042,Exterior - Addition	None Detected		100% Other	Gray Non Fibrous Homogeneous
71965751PLM_16					Ashed

**Disclaimer:** Due to the nature of the EPA 600 method, asbestos may not be detected in samples containing low levels of asbestos. We strongly recommend that analysis of floor tiles, vermiculite, and/or heterogeneous soil samples be conducted by TEM for confirmation of "None Detected" by PLM. This report relates only to the samples tested and may not be reproduced, except in full, without the written approval of SAL. This report may not be used by the client to claim product endorsement by NVLAP or any other agency of the U.S. government. Analytical uncertainty available upon request. Scientific Analytical Institute participates in the NVLAP Proficiency Testing program. Unless otherwise noted blank sample correction was not performed. Estimated MDL is 0.1%.

Yanelis Delgado (21)

Analyst

Approved Signatory





# Bulk Asbestos Analysis

By Polarized Light Microscopy  
EPA Method: 600/R-93/116 and 40 CFR, Part 763, Subpart E,  
App.E



**Customer:** Pinchin Ltd.  
6-875 Main St West  
Suite 200  
Hamilton, Ontario L8S 4P9

**Attn:** Matt Pitman  
Emily Balfour

**Lab Order ID:** 71965751  
**Analysis ID:** 71965751\_PLM  
**Date Received:** 5/17/2021  
**Date Reported:** 5/19/2021

**Project:** HWCDSB 135 Hester Street, ON, Hamilton St. Michael Catholic School 286533.002

Sample ID	Description	Asbestos	Fibrous Components	Non-Fibrous Components	Attributes
Lab Sample ID	Lab Notes				Treatment
S0011B	Wall,Caulking,White Caulking,Loc:1042,Exterior - Addition	<b>None Detected</b>		<b>100% Other</b>	Gray Non Fibrous Homogeneous
71965751PLM_17					Ashed
S0011C	Wall,Caulking,White Caulking,Loc:1042,Exterior - Addition	<b>None Detected</b>		<b>100% Other</b>	Gray Non Fibrous Homogeneous
71965751PLM_18					Ashed
S0012A	Wall,Unidentified Material,Bell And Spigot Packing,Loc:1041,Exterior - O	<b>20% Amosite 10% Chrysotile</b>		<b>70% Other</b>	Gray Non Fibrous Heterogeneous
71965751PLM_19					Crushed
S0012B	Wall,Unidentified Material,Bell And Spigot Packing,Loc:1041,Exterior - O	<b>Not Analyzed</b>			
71965751PLM_20					
S0012C	Wall,Unidentified Material,Bell And Spigot Packing,Loc:1041,Exterior - O	<b>Not Analyzed</b>			
71965751PLM_21					

**Disclaimer:** Due to the nature of the EPA 600 method, asbestos may not be detected in samples containing low levels of asbestos. We strongly recommend that analysis of floor tiles, vermiculite, and/or heterogeneous soil samples be conducted by TEM for confirmation of "None Detected" by PLM. This report relates only to the samples tested and may not be reproduced, except in full, without the written approval of SAL. This report may not be used by the client to claim product endorsement by NVLAP or any other agency of the U.S. government. Analytical uncertainty available upon request. Scientific Analytical Institute participates in the NVLAP Proficiency Testing program. Unless otherwise noted blank sample correction was not performed. Estimated MDL is 0.1%.

Yanelis Delgado (21)

Analyst

Approved Signatory

Waiting on Ecoc.

Received by: 71965751  
 Received on: \_\_\_\_\_

**Pinchin Ltd. - Asbestos Laboratory  
 Internal Asbestos Bulk Sample Chain of Custody**

<b>Client Name:</b>	HWCD SB	<b>Project Address:</b>	135 Hester Street, ON, Hamilton
<b>Portfolio/Building No:</b>	St. Michael Catholic School	<b>Pinchin File:</b>	286533.002
<b>Submitted by:</b>	Matt Pitman	<b>Email:</b>	mpitman@pinchin.com
<b>CC Results to:</b>	Emily Balfour	<b>CC Email:</b>	ebalfour@pinchin.com
<b>Date Submitted:</b>	May 13 2021	<b>Required by:</b>	May 20 2021
<b># of Samples:</b>	21	<b>Priority:</b>	5 Day Turnaround
<b>Year of Building Construction (Mandatory, Years ONLY):</b>	1966		
<b>Do NOT Stop on Positive (Sample Numbers):</b>			
<b>Pinchin Group Company (Mandatory Field):</b>	Pinchin		
<b>HMIS2 Building Reference #:</b>	23604/201807063683556		

**To be Completed by Lab Personnel Only:**

<b>Lab Reference #:</b>	<b>Time:</b>	24 hour clock
<b>Received by:</b>	<b>Date:</b>	Month Day Year
<b>Name(s) of Analyst(s):</b>		

Sample Prefix	Sample No.	Sample Suffix	Sample Description/Location (Mandatory)
S	0006	A	Wall,Caulking,Brown Caulking,Loc:1041,Exterior - Old Section
S	0006	B	Wall,Caulking,Brown Caulking,Loc:1041,Exterior - Old Section
S	0006	C	Wall,Caulking,Brown Caulking,Loc:1041,Exterior - Old Section
S	0007	A	Wall,Caulking,Light Grey Caulking,Loc:1041,Exterior - Old Section <b>Accepted</b> <input checked="" type="checkbox"/>
S	0007	B	Wall,Caulking,Light Grey Caulking,Loc:1041,Exterior - Old Section <b>Rejected</b> <input type="checkbox"/>
S	0007	C	Wall,Caulking,Light Grey Caulking,Loc:1041,Exterior - Old Section
S	0008	A	Wall,Caulking,Dark Grey Caulking,Loc:1041,Exterior - Old Section
S	0008	B	Wall,Caulking,Dark Grey Caulking,Loc:1041,Exterior - Old Section
S	0008	C	Wall,Caulking,Dark Grey Caulking,Loc:1041,Exterior - Old Section
S	0009	A	Wall,Caulking,Beige Caulking,Loc:1041,Exterior - Old Section

**Accepted**   
**Rejected**   
*5/17*  
*10 max*

S	0009	B	Wall,Caulking,Beige Caulking,Loc:1041,Exterior - Old Section
S	0009	C	Wall,Caulking,Beige Caulking,Loc:1041,Exterior - Old Section
S	0010	A	Wall,Caulking,White Caulking,Loc:1041,Exterior - Old Section
S	0010	B	Wall,Caulking,White Caulking,Loc:1041,Exterior - Old Section
S	0010	C	Wall,Caulking,White Caulking,Loc:1041,Exterior - Old Section
S	0011	A	Wall,Caulking,White Caulking,Loc:1042,Exterior - Addition
S	0011	B	Wall,Caulking,White Caulking,Loc:1042,Exterior - Addition
S	0011	C	Wall,Caulking,White Caulking,Loc:1042,Exterior - Addition
S	0012	A	Wall,Unidentified Material,Bell and Spigot Packing,Loc:1041,Exterior - Addition
S	0012	B	Wall,Unidentified Material,Bell and Spigot Packing,Loc:1041,Exterior - Addition
S	0012	C	Wall,Unidentified Material,Bell and Spigot Packing,Loc:1041,Exterior - Addition



Your Project #: 320582.003  
 Site Location: ST.MICHAEL  
 Your C.O.C. #: n/a

**Attention: Emily Balfour**

Pinchin Ltd  
 Unit 6  
 875 Main St W  
 Hamilton, ON  
 CANADA L8S 4R9

**Report Date: 2023/02/22**  
 Report #: R7518724  
 Version: 1 - Final

**CERTIFICATE OF ANALYSIS**

**BUREAU VERITAS JOB #: C349346**

**Received: 2023/02/21, 08:00**

Sample Matrix: Solid  
 # Samples Received: 3

Analyses	Quantity	Date Extracted	Date Analyzed	Laboratory Method	Analytical Method
Asbestos by PLM - 0.5 RDL (1)	3	N/A	N/A	COR3SOP-00002	EPA 600R-93/116

**Remarks:**

Bureau Veritas is accredited to ISO/IEC 17025 for specific parameters on scopes of accreditation. Unless otherwise noted, procedures used by Bureau Veritas are based upon recognized Provincial, Federal or US method compendia such as CCME, MELCC, EPA, APHA.

All work recorded herein has been done in accordance with procedures and practices ordinarily exercised by professionals in Bureau Veritas' profession using accepted testing methodologies, quality assurance and quality control procedures (except where otherwise agreed by the client and Bureau Veritas in writing). All data is in statistical control and has met quality control and method performance criteria unless otherwise noted. All method blanks are reported; unless indicated otherwise, associated sample data are not blank corrected. Where applicable, unless otherwise noted, Measurement Uncertainty has not been accounted for when stating conformity to the referenced standard.

Bureau Veritas liability is limited to the actual cost of the requested analyses, unless otherwise agreed in writing. There is no other warranty expressed or implied. Bureau Veritas has been retained to provide analysis of samples provided by the Client using the testing methodology referenced in this report. Interpretation and use of test results are the sole responsibility of the Client and are not within the scope of services provided by Bureau Veritas, unless otherwise agreed in writing. Bureau Veritas is not responsible for the accuracy or any data impacts, that result from the information provided by the customer or their agent.

Solid sample results, except biota, are based on dry weight unless otherwise indicated. Organic analyses are not recovery corrected except for isotope dilution methods.

Results relate to samples tested. When sampling is not conducted by Bureau Veritas, results relate to the supplied samples tested. This Certificate shall not be reproduced except in full, without the written approval of the laboratory.

Bureau Veritas' Asbestos Laboratory is accredited by NVLAP for bulk asbestos analysis by polarized light microscopy, NVLAP Code 600136-0.

This report may not be reproduced, except in full, without the written approval of Bureau Veritas. This report may not be used by the client to claim product certification, approval, or endorsement by NVLAP, NIST or any other agency of the U.S. Government.

Bureau Veritas' scope of accreditation includes EPA -- 40 CFR Appendix E to Subpart E of Part 763, "Interim Method for the Determination of Asbestos in Bulk Insulation Samples" and EPA-600/R-93/116: "Method for the Determination of Asbestos in Bulk Building Materials".

Reference Method suffix "m" indicates test methods incorporate validated modifications from specific reference methods to improve performance.

\* RPDs calculated using raw data. The rounding of final results may result in the apparent difference.

(1) P.O.B. - Percent of Bulk



Your Project #: 320582.003  
Site Location: ST.MICHAEL  
Your C.O.C. #: n/a

**Attention: Emily Balfour**

Pinchin Ltd  
Unit 6  
875 Main St W  
Hamilton, ON  
CANADA L8S 4R9

**Report Date: 2023/02/22**  
Report #: R7518724  
Version: 1 - Final

**CERTIFICATE OF ANALYSIS**

**BUREAU VERITAS JOB #: C349346**

**Received: 2023/02/21, 08:00**

When Asbestos data is reported with other data, this report contains data that are not covered by the NVLAP accreditation.

**Encryption Key**

Please direct all questions regarding this Certificate of Analysis to:

Nilushi Mahathantila, Project Manager  
Email: Nilushi.Mahathantila@bureauveritas.com  
Phone# (905) 817-5700

=====

This report has been generated and distributed using a secure automated process.

Bureau Veritas has procedures in place to guard against improper use of the electronic signature and have the required "signatories", as per ISO/IEC 17025, signing the reports. For Service Group specific validation, please refer to the Validation Signatures page if included, otherwise available by request. For Department specific Analyst/Supervisor validation names, please refer to the Test Summary section if included, otherwise available by request. This report is authorized by Rodney Major, General Manager responsible for Ontario Environmental laboratory operations.



Bureau Veritas Job #: C349346  
 Report Date: 2023/02/22

Pinchin Ltd  
 Client Project #: 320582.003  
 Site Location: ST.MICHAEL  
 Sampler Initials: EB

**Asbestos Analytical Results**

EPA/600R-93/116 by Polarized Light Microscopy

<b>S0013A FLOOR, TERRAZZO,LOC:1014,STAIRWELL 2</b>						
Bureau Veritas ID: VCJ383		Date Analyzed: 2023/02/22				
	<u>P.O.B</u>	<u>Sample Morphology</u>	<u>Asbestos</u>		<u>Other Fibres</u>	<u>Particulate</u>
Layer 1	20	Homogeneous light grey/brown cementitious material	<b>Chrysotile</b>	<0.50%		Non-Fibrous
Layer 2	80	Homogeneous grey cementitious material	Not Detected			Non-Fibrous

<b>S0013B FLOOR, TERRAZZO,LOC:1014,STAIRWELL 2</b>						
Bureau Veritas ID: VCJ384		Date Analyzed: 2023/02/22				
	<u>P.O.B</u>	<u>Sample Morphology</u>	<u>Asbestos</u>		<u>Other Fibres</u>	<u>Particulate</u>
Layer 1	20	Homogeneous light grey/brown cementitious material	<b>Chrysotile</b>	<0.50%		Non-Fibrous
Layer 2	80	Homogeneous grey cementitious material	Not Detected			Non-Fibrous

The limit of quantitation is 0.50%, although asbestos may be qualitatively detected at concentrations less than 0.50%. Samples for which asbestos is detected at <0.50% are reported as trace, "<0.50%". "Not Detected" indicates that no asbestos fibres were observed.

Calibrated Visual Estimate (%)  
 Date Format : yyyy/mm/dd



BUREAU  
VERITAS

Bureau Veritas Job #: C349346  
Report Date: 2023/02/22

Pinchin Ltd  
Client Project #: 320582.003  
Site Location: ST.MICHAEL  
Sampler Initials: EB

### Asbestos Analytical Results

EPA/600R-93/116 by Polarized Light Microscopy

<b>S0013C FLOOR, TERRAZZO,LOC:1014,STAIRWELL 2</b>						
Bureau Veritas ID:		VCJ385	Date Analyzed:		2023/02/22	
	<u>P.O.B</u>	<u>Sample Morphology</u>	<u>Asbestos</u>		<u>Other Fibres</u>	<u>Particulate</u>
Layer 1	20	Homogeneous light grey/brown cementitious material	<b>Chrysotile</b>	<0.50%		Non-Fibrous
Layer 2	80	Homogeneous grey cementitious material	Not Detected			Non-Fibrous

The limit of quantitation is 0.50%, although asbestos may be qualitatively detected at concentrations less than 0.50%. Samples for which asbestos is detected at <0.50% are reported as trace, "<0.50%". "Not Detected" indicates that no asbestos fibres were observed.

Calibrated Visual Estimate (%)  
Date Format : yyyy/mm/dd



**BUREAU  
VERITAS**

Bureau Veritas Job #: C349346  
Report Date: 2023/02/22

Pinchin Ltd  
Client Project #: 320582.003  
Site Location: ST.MICHAEL  
Sampler Initials: EB

### GENERAL COMMENTS

Results relate only to the items tested.





BUREAU  
VERITAS

Bureau Veritas Job #: C349346  
Report Date: 2023/02/22

Pinchin Ltd  
Client Project #: 320582.003  
Site Location: ST.MICHAEL  
Sampler Initials: EB

### VALIDATION SIGNATURE PAGE

The analytical data and all QC contained in this report were reviewed and validated by:

---

Jon Delos Santos, Laboratory Supervisor

---

---

Bureau Veritas has procedures in place to guard against improper use of the electronic signature and have the required "signatories", as per ISO/IEC 17025, signing the reports. For Service Group specific validation, please refer to the Validation Signatures page if included, otherwise available by request. For Department specific Analyst/Supervisor validation names, please refer to the Test Summary section if included, otherwise available by request. This report is authorized by {0}, {1} responsible for {2} {3} laboratory operations.

*iHS 100*

**Pinchin Ltd. - Asbestos Laboratory  
Internal Asbestos Bulk Sample Chain of Custody**

<b>Client Name:</b>		<b>Project Address:</b>	
<b>Portfolio/Building No:</b>	St. Michael	<b>Pinchin File:</b>	320582.003
<b>Submitted by:</b>	Emily Balfour	<b>Email:</b>	ebalfour@pinchin.com
<b>CC Results to:</b>		<b>CC Email:</b>	
<b>Date Submitted:</b>	February 17 2023	<b>Required by:</b>	February 22 2023
<b># of Samples:</b>	3	<b>Priority:</b>	Rush Turnaround
<b>Year of Building Construction (Mandatory, Years ONLY):</b>			
<b>Do NOT Stop on Positive (Sample Numbers):</b>			
<b>Pinchin Group Company (Mandatory Field):</b>			Pinchin
<b>HMIS2 Building Reference #:</b>			23604/201807063683556
<b>To be Completed by Lab Personnel Only:</b>			
<b>Lab Reference #:</b>		<b>Time:</b> 8:00	24 hour clock
<b>Received by:</b>	Rupinder / RUPINDER	<b>Date:</b> 2023/02/21	Month Day Year
<b>Name(s) of Analyst(s):</b>			
Sample Prefix	Sample No.	Sample Suffix	Sample Description/Location (Mandatory)
S	0013	A	Floor,Terrazzo,Loc:1014,Stairwell 2
S	0013	B	Floor,Terrazzo,Loc:1014,Stairwell 2
S	0013	C	Floor,Terrazzo,Loc:1014,Stairwell 2

21-Feb-23 08:00  
 Julie Clement  
  
 C349346  
 RUK ENV-1119

**APPENDIX II**  
**Location List**

**Client:** Hamilton-Wentworth Catholic District Sch  
**Building Name:** St. Michael  
**Survey Date:** 2018-07-13  
**Building Phases:** A: 1966 , B: 2005

**Site:** 135 Hester Street, Hamilton, ON  
**Last Re-Assessment:** 2023-03-30

Location No.	Name or Description	Area ft <sup>2</sup>	Floor No.	Bldg. Phase	Notes
1	Presumed Asbestos-Containing Materials	0		A	
1000	Classroom 7	0	1	A	
1001	Stairwell 1	0	1	A	
1002	Classroom 6	0	1	A	
1003	Corridor	0	1	A	
1004	Classroom 5	0	1	A	
1005	Main Office	0	1	A	
1006	Principals Office	0	1	A	
1007	Front Entrance	0	1	A	
1008	Corridor	0	1	A	
1009	Girls Washroom	0	1	A	
1010	Staff Room	0	1	A	
1011	Classroom 3	0	1	A	
1012	Classroom 1	0	1	A	
1013	Storage	0	1	A	
1014	Stairwell 2	0	1	A	
1015	Classroom 2	0	1	A	
1016	Classroom 4	0	1	A	
1017	Boiler Room	0	1	A	
1018	Boys Washroom	0	1	A	
1019	Special Needs Washroom	0	1	A	
1020	Corridor	0	1	A	
1021	Back Room	0	1	A	
1022	Kitchen	0	1	A	
1023	Electrical Room	0	1	A	
1024	Library Storage	0	1	A	
1025	Corridor	0	1	A	
1026	Storage	0	1	A	
1027	Corridor	0	1	A	
1028	Computer Lab	0	1	A	
1029	Corridor	0	1	B	
1030	Gym Corridor	0	1	B	
1031	Boys Washroom	0	1	B	
1032	Boys Shower	0	1	B	
1033	Girls' Washroom	0	1	B	
1034	Girls Shower	0	1	B	
1035	Gym Kitchen	0	1	B	
1036	Gym Storage	0	1	B	
1037	Gymnasium	0	1	B	
1039	Vice Principal Office	0	1	A	
1040	Library	0	1	A	
1041	Exterior - Original	0	1	A	
1042	Exterior - Addition	0	1	B	
2000	Classroom 14	0	1	A	
2001	Classroom 12	0	1	A	
2002	Stairwell	0	1	A	
2003	Classroom 15	0	1	A	
2004	Classroom 13	0	1	A	
2005	Corridor	0	1	A	
2006	Corridor	0	1	A	
2007	Stairwell	0	1	A	
2008	Boys Washroom	0	1	A	
2009	French Resource	0	1	A	
2010	Staff Room	0	1	A	
2011	Staff Washroom	0	1	A	
2012	Womans Staff Washroom	0	1	A	
2013	Classroom 11	0	2	A	
2014	Classroom 10	0	2	A	
2015	Storage	0	2	A	
2016	Storage Sink Room	0	2	A	
2017	Washroom	0	2	A	

Location No.	Name or Description	Area ft <sup>2</sup>	Floor No.	Bldg. Phase	Notes
2018	Classroom 8	0	2	A	
2019	Classroom 9	0	2	A	
2020	Stairwell	0	2	A	
2021	Girl's Washroom	0	2	A	
2022	Storage	0	2	A	

**APPENDIX III**

**Hazardous Materials Summary / Sample Log Report**

Client: Hamilton-Wentworth Catholic District Sch

Site: 135 Hester Street, Hamilton, ON

Building Name: St. Michael

Survey Date: 2018-07-13

HAZMAT	Sample No	System/Component/Material/Sample Description	Locations	Bldg. Phase	LF	SF	EA	%	Type	Positive	Friability
Asbestos	S0001 ABC	Ceiling   Soffit   Plaster	1041	A	0	0	0	100	Chrysotile	Yes	PF
Asbestos	S0002 ABCDEFG	Ceiling, Wall, Ceiling, Wall     Plaster	1001,1005,1006,1009,1010,1014,1015,1018,1019,1021,1022,1023,2002,2008,2011,2012,2016,2017,2021	A	0	0	0	100	None Detected	No	
Asbestos	S0003 ABC	Wall, Ceiling, Wall   Column, Bulkhead   Drywall And Joint Compound	1000,1005,1006,1012,1015,1016,1022,1023,1024,1026,1028,1039,1040	A	0	0	0	100	None Detected	No	
Asbestos	S0004 ABC	Piping     Parging Cement	1003,1018	A	0	0	17	0	Chrysotile	Yes	F
Asbestos	S0005 ABC	Piping   Rain Water Leader   Sweatwrap	2005	A	5	0	0	0	None Detected	No	
Asbestos	S0006 ABC	Wall     Caulking   Brown Caulking	1041	A	0	0	0	100	None Detected	No	
Asbestos	S0007 ABC	Wall     Caulking   Light Grey Caulking	1041	A	0	0	0	100	None Detected	No	
Asbestos	S0008 ABC	Wall     Caulking   Dark Grey Caulking	1041	A	0	0	0	100	None Detected	No	
Asbestos	S0009 ABC	Wall     Caulking   Beige Caulking	1041	A	0	0	0	100	None Detected	No	
Asbestos	S0010 ABC	Wall     Caulking   White Caulking	1041	A	0	0	0	0	Chrysotile	Yes	NF
Asbestos	S0011 ABC	Wall     Caulking   White Caulking	1042	B	0	0	0	100	None Detected	No	
Asbestos	S0012 ABC	Wall     Unidentified Material   Bell And Spigot Packing	1041	A	0	0	0	100	Amosite	Yes	[PF]*
Asbestos	S0013 ABC	Floor     Terrazzo	1001,1014,2002,2007,2020	A	0	0	0	100	Chrysotile	No	
Asbestos	V9500	Floor     Mastic	1000,1002,1004,1011,1012,1013,1015,1016,1023,1024,1026,1028,1040,2000,2003,2009,2010,2013,2014	A	0	0	0	100	Presumed Asbestos	Yes	NF
Asbestos	V9500	Floor     Vinyl Floor Tile And Mastic   12x12 Beige With Orange Flecks, 12x12 Beige With Yellow Flecks, 12x12 Mint With Grey Fleck, 12x12 Pink Dense Fleck, 12x12 Salmon With Brown Streaks, 12x12 Salmon With White Flecks, 12x12 Tan With Brown Streaks	1009,1010,2001,2004,2015,2018,2019,2022	A	0	0	0	100	Presumed Asbestos	Yes	NF
Asbestos	V9500	Floor     Vinyl Sheet Flooring   Off-white With Dark Flecks	2001,2019	A	0	20	0	0	Presumed Asbestos	Yes	PF
Asbestos	V9500	Other     N/a   Roofing Felts And Tar, Mastics, Floor Levelling Compound, Ceramic Tile Setting Compound, Electrical Components, Mechanical Packing, Ropes And Gaskets, Vermiculite, Adhesives And Duct Mastics, Caulking And Putties, Fibre-reinforced Paints And Coatings, Paper Products, Soffit And Fascia Boards, Fire Resistant Doors, Stucco,	1	A	0	0	0	100	Presumed Asbestos	Yes	NF

HAZMAT	Sample No	System/Component/Material/Sample Description	Locations	Bldg. Phase	LF	SF	EA	%	Type	Positive	Friability
		Plaster Or Other Cementitious Parge Coatings, Vibration Dampers On Hvac Equipment, Terrazzo Where Not Sampled, Ropes And Gaskets In Cast-iron Bell And Spigot Joints, Sealants On Pipe Threads									
Asbestos	V0000	Ceiling     Ceiling Tiles (lay-in)	1012	A	0	0	0	100	Non Asbestos	No	
Asbestos	V0000	Ceiling     Ceiling Tiles (lay-in)   2 X 4' Dense Fleck (2005)	1040	A	0	0	0	100	Non Asbestos	No	
Asbestos	V0000	Ceiling     Ceiling Tiles (lay-in)   2' X 4' Pinhole And Round Flecks (2012)	1008	A	0	0	0	100	Non Asbestos	No	
Asbestos	V0000	Ceiling     Ceiling Tiles (lay-in)   2' X 4' Short Fissure Random Pinhole (2005)	1005	A	0	0	0	100	Non Asbestos	No	
Asbestos	V0000	Ceiling     Ceiling Tiles (lay-in)   2' X 4' Flat Face	1033	B	0	0	0	100	Non Asbestos	No	
Asbestos	V0000	Ceiling     Ceiling Tiles (lay-in)   2' X 4' Flat Face (gypsum)	1031	B	0	0	0	100	Non Asbestos	No	
Asbestos	V0000	Ceiling     Ceiling Tiles (lay-in)   2' X 4' Long	2006	A	0	0	0	100	Non Asbestos	No	
Asbestos	V0000	Ceiling     Ceiling Tiles (lay-in)   2' X 4' Long Fissure Random Pinhole (2012)	1013,1021,1027,1030	A,B	0	0	0	100	Non Asbestos	No	
Asbestos	V0000	Ceiling     Ceiling Tiles (lay-in)   2' X 4' Pinhole And Round Flecks (2012)	1010	A	0	0	0	100	Non Asbestos	No	
Asbestos	V0000	Ceiling     Ceiling Tiles (lay-in)   2' X 4' Short Fissure Random Pinhole (2005)	1001,1003,1013,1020,1024,1025,1026,1029,1039	A,B	0	0	0	100	Non Asbestos	No	
Asbestos	V0000	Ceiling     Ceiling Tiles (lay-in)   2' X 4' Smooth Gypsum Board	1019	A	0	0	0	100	Non Asbestos	No	
Asbestos	V0000	Ceiling     Ceiling Tiles (lay-in)   2' X 4' Textured Pinhole	2005,2006	A	0	0	0	100	Non Asbestos	No	
Asbestos	V0000	Ceiling     Ceiling Tiles (lay-in)   2' X 4' Textured Pinhole (fiberglass)	1014	A	0	0	0	0	Non Asbestos	No	
Asbestos	V0000	Ceiling     Ceiling Tiles (lay-in)   2x4 Short Fissure Random Pinhole (2005)	1006	A	0	0	0	100	Non Asbestos	No	
Asbestos	V0000	Ceiling     Ceiling Tiles (lay-in)   2x4 Pinhole And Small Fleck (new)	1011	A	0	0	0	100	Non Asbestos	No	
Asbestos	V0000	Ceiling     Ceiling Tiles (lay-in)   Long	2005,2015	A	0	0	0	100	Non Asbestos	No	
Asbestos	V0000	Ceiling   Acoustic Tile   Ceiling Tiles (lay-in)   Pinhole (24x48) Pinhole	2000	A	0	0	0	0	Non Asbestos	No	
Asbestos	V0000	Ceiling     Drywall And Joint Compound	1032,1034,1035	B	0	0	0	100	Non Asbestos	No	
Asbestos	V0000	Ceiling     Masonry	1006,2019	A	0	0	0	100	Non Asbestos	No	
Asbestos	V0000	Floor     Carpet	1005,1039,1040,2019	A	0	0	0	100	Non	No	



HAZMAT	Sample No	System/Component/Material/Sample Description	Locations	Bldg. Phase	LF	SF	EA	%	Type	Positive	Friability
Asbestos	V0000	Floor    Ceramic Tiles	1025,1027,1029,1032,1034	A,B	0	0	0	100	Asbestos Non Asbestos	No	
Asbestos	V0000	Floor    Concrete (poured)	1017	A	0	0	0	100	Non Asbestos	No	
Asbestos	V0000	Floor    Vinyl Floor Tile   12" X 12" Beige With Brown Fleck (2015)	1004	A	0	0	0	100	Non Asbestos	No	
Asbestos	V0000	Floor    Vinyl Floor Tile (no Mastic)   12" X 12" Beige With Brown Fleck (2006)	2003	A	0	0	0	100	Non Asbestos	No	
Asbestos	V0000	Floor    Vinyl Floor Tile (no Mastic)   12" X 12" Beige With Brown Fleck (2015)	1012,1013,1015,1016	A	0	0	0	100	Non Asbestos	No	
Asbestos	V0000	Floor    Vinyl Floor Tile (no Mastic)   12" X 12" Beige With White Fleck	1028	A	0	0	0	100	Non Asbestos	No	
Asbestos	V0000	Floor    Vinyl Floor Tile (no Mastic)   12" X 12" Beige With White Fleck (2006)	1023,1024,1026,1040	A	0	0	0	100	Non Asbestos	No	
Asbestos	V0000	Floor    Vinyl Floor Tile (no Mastic)   12" X 12" Brown With Brown Fleck (2015)	1000	A	0	0	0	100	Non Asbestos	No	
Asbestos	V0000	Floor    Vinyl Floor Tile (no Mastic)   12" X 12" Grey Dense Flecks (installed 2021)	2000	A	0	0	0	100	Non Asbestos	No	
Asbestos	V0000	Floor    Vinyl Floor Tile (no Mastic)   12" X 12" Grey With Grey Fleck (2006)	1036	B	0	0	0	100	Non Asbestos	No	
Asbestos	V0000	Floor    Vinyl Floor Tile And Mastic   12" X 12" Beige With White Fleck (2006)	1031,1033,1035	B	0	0	0	100	Non Asbestos	No	
Asbestos	V0000	Floor    Vinyl Sheet Flooring   Faux Wood (2006)	1037	B	0	0	0	100	Non Asbestos	No	
Asbestos	V0000	Floor    Wood   Laminate	1005	A	0	0	0	100	Non Asbestos	No	
Asbestos	V0000	Piping    Fibreglass	1005,1006,1008,1013,1017,1018,1019,1020,1021,1024,1026,1027,1028,1029,1030,1031,1033,1036,1037,1039	A,B	0	0	0	100	Non Asbestos	No	
Asbestos	V0000	Piping    Not Insulated	1022	A	0	0	0	100	Non Asbestos	No	
Asbestos	V0000	Piping    Sweatwrap	1018	A	0	0	0	0	Non Asbestos	No	
Asbestos	V0000	Structure    Concrete (precast)	1000,1001,1002,1004,1007,1011,1012,1015,1016,1017,1022,1023,1039,2000,2001,2002,2003,2004,2007,2010,2013,2014,2018,2020,2022	A	0	0	0	100	Non Asbestos	No	
Asbestos	V0000	Structure   Deck   Steel	1036,1037	B	0	0	0	100	Non Asbestos	No	
Asbestos	V0000	Wall    Ceramic Tiles	1007,1032,1034,2005,2006,2007	A,B	0	0	0	100	Non Asbestos	No	
Asbestos	V0000	Wall    Drywall And Joint Compound   New	1011,2010	A	0	0	0	100	Non Asbestos	No	
Asbestos	V0000	Wall   All   Masonry	1000,1001,1002,1003,1004,1005,1006,1008,1009	A,B	0	0	0	100	Non	No	

HAZMAT	Sample No	System/Component/Material/Sample Description	Locations	Bldg. Phase	LF	SF	EA	%	Type	Positive	Friability
			1010,1011,1012,1013,1014,1015,1016,1017,1018 1019,1020,1021,1022,1023,1024,1025,1026,1027 1028,1029,1030,1031,1032,1033,1034,1035,1036 1037,1039,1040,2000,2001,2002,2003,2004,2005 2006,2008,2009,2010,2011,2012,2013,2014,2015 2016,2017,2018,2019,2020,2021,2022						Asbestos		
Asbestos	V0000	Wall     Wood	1003,2008	A	0	0	0	100	Non Asbestos	No	
Asbestos	V0000	Wall     Wood   Panels	1008,1017,1018,1020	A	0	0	0	100	Non Asbestos	No	

## Legend:

Sample number		Units		
S####	Asbestos sample collected	SF	Square feet	NF Non Friable material.
L####	Paint sample collected	LF	Linear feet	F Friable material
P####	PCB sample collected	EA	Each	PF Potentially Friable material
M####	Mould sample collected	%	Percentage	
V####	Material visually similar to numbered sample collected			
V0000	Known non Hazardous Material			
V9000	Material is visually identified as Hazardous Material			
V9500	Material is presumed to be Hazardous Material			
[Loc. No.]	Abated Material			

**APPENDIX IV**  
**All Data Report**

**Client:** Hamilton-Wentworth Catholic District Sch  
**Location:** #1 : Presumed Asbestos-Containing Materials  
**Survey Date:** 2018-07-13

**Site:** Elementary  
**Floor:** Basement (0)

**Building Name:** St. Michael

**Room #:**

**Area (sqft):** 0

**Last Re-Assessment:** 2023-03-30

ASBESTOS																
System	Component	Material	Item	Covering	A*	V*	AP*	Good	Fair	Poor	Unit	Sample	Asbestos Type	Amount	Hazard	Friable
Other		N/A, Roofing felts and tar, mastics, Floor levelling compound, Ceramic tile setting compound, Electrical components, Mechanical packing, ropes and gaskets, Vermiculite, Adhesives and duct mastics, Caulking and putties, Fibre-reinforced paints and coatings, Paper products, Soffit and fascia boards, Fire resistant doors, Stucco, plaster or other cementitious parge coatings, Vibration dampers on HVAC equipment, Terrazzo where not sampled, Ropes and gaskets in cast-iron bell and spigot joints, Sealants on pipe threads			D	N		100(7)			%	V9500	Presumed Asbestos		Presumed Asbestos	NF

**Client:** Hamilton-Wentworth Catholic District Sch  
**Location:** #1000 : Classroom 7  
**Survey Date:** 2018-07-13

**Site:** Elementary  
**Floor:** 1

**Building Name:** St. Michael

**Room #:**

**Area (sqft):** 0

**Last Re-Assessment:** 2023-03-30

ASBESTOS																
System	Component	Material	Item	Covering	A*	V*	AP*	Good	Fair	Poor	Unit	Sample	Asbestos Type	Amount	Hazard	Friable
Ceiling	Bulkhead	Drywall and joint compound			C	Y		100			%	V0003	None Detected	N.D.	None	
Floor		Mastic			D	N		100(7)			%	V9500	Presumed Asbestos		Presumed Asbestos	NF
Floor		Vinyl Floor Tile (No Mastic), 12" x 12" brown with brown fleck (2015)			A	Y		100			%	V0000	Non-Asbestos		None	
Piping <sup>1</sup>		Unidentified Material			D	N										
Structure		Concrete (precast)			C	Y		100			%	V0000	Non-Asbestos		None	
Wall		Masonry			A	Y		100			%	V0000	Non-Asbestos		None	

1 - Inaccessible enclosure behind/above closet

**Client:** Hamilton-Wentworth Catholic District Sch  
**Location:** #1001 : Stairwell 1  
**Survey Date:** 2018-07-13

**Site:** Elementary  
**Floor:** 1

**Building Name:** St. Michael  
**Room #:**  
**Last Re-Assessment:** 2023-03-30

**Area (sqft):** 0

ASBESTOS																
System	Component	Material	Item	Covering	A*	V*	AP*	Good	Fair	Poor	Unit	Sample	Asbestos Type	Amount	Hazard	Friable
Ceiling		Ceiling Tiles (lay-in), 2' x 4' short fissure random pinhole (2005)			C	Y		100			%	V0000	Non-Asbestos		None	
Floor		Terrazzo			A	Y						V0013	Chrysotile	<0.5%	None	
Structure		Concrete (precast)			C	N		100			%	V0000	Non-Asbestos		None	
Wall		Plaster			C	Y		100			%	V0002	None Detected	N.D.	None	
Wall		Masonry			A	Y		100			%	V0000	Non-Asbestos		None	

**Client:** Hamilton-Wentworth Catholic District Sch  
**Location:** #1002 : Classroom 6  
**Survey Date:** 2018-07-13

**Site:** Elementary  
**Floor:** 1

**Building Name:** St. Michael  
**Room #:**  
**Last Re-Assessment:** 2023-03-30

**Area (sqft):** 0

ASBESTOS																
System	Component	Material	Item	Covering	A*	V*	AP*	Good	Fair	Poor	Unit	Sample	Asbestos Type	Amount	Hazard	Friable
Floor		Vinyl Floor Tile and Mastic, 12" x 12" beige with white fleck			A	Y		100			%	V9500	[None]		[Abated]	
Floor		Vinyl Floor Tile and Mastic, 12" x 12" mint with grey fleck			A	Y		100			%	V9500	[None]		[Abated]	
Floor		Vinyl Floor Tile and Mastic, 12" x 12" Beige with grey streak			A	Y		100			%	V9500	[None]		[Abated]	
Floor		Mastic		Laminate	D	N						V9500	Presumed Asbestos		Presumed Asbestos	NF
Structure		Concrete (precast)			C	Y		100			%	V0000	Non-Asbestos		None	
Wall		Masonry			A	Y		100			%	V0000	Non-Asbestos		None	

**Client: Hamilton-Wentworth Catholic District Sch**  
**Location: #1003 : Corridor**  
**Survey Date: 2018-07-13**

**Site: Elementary**  
**Floor: 1**

**Building Name: St. Michael**  
**Room #:**  
**Last Re-Assessment: 2023-03-30**

**Area (sqft): 0**

ASBESTOS																
System	Component	Material	Item	Covering	A*	V*	AP*	Good	Fair	Poor	Unit	Sample	Asbestos Type	Amount	Hazard	Friable
Ceiling		Ceiling Tiles (lay-in), 2' x 4' short fissure random pinhole (2005)			C	Y		100			%	V0000	Non-Asbestos		None	
Floor		Terrazzo			A	Y		100			%					
Piping		Fibreglass			C	N										
Piping		Parging Cement	Fitting		C	N		14(7)	1(7)		EA	S0004ABC	Chrysotile	50-75%	Confirmed Asbestos	F
Wall		Wood			A	Y						V0000	Non-Asbestos		None	
Wall		Masonry			A	Y		100			%	V0000	Non-Asbestos		None	

**Client: Hamilton-Wentworth Catholic District Sch**  
**Location: #1004 : Classroom 5**  
**Survey Date: 2018-07-13**

**Site: Elementary**  
**Floor: 1**

**Building Name: St. Michael**  
**Room #:**  
**Last Re-Assessment: 2023-03-30**

**Area (sqft): 0**

ASBESTOS																
System	Component	Material	Item	Covering	A*	V*	AP*	Good	Fair	Poor	Unit	Sample	Asbestos Type	Amount	Hazard	Friable
Floor		Mastic		Vinyl Floor Tile	D	N		100(7)			%	V9500	Presumed Asbestos		Presumed Asbestos	NF
Floor		Vinyl Floor Tile, 12" x 12" beige with brown fleck (2015)			A	Y		100			%	V0000	Non-Asbestos		None	
Piping <sup>1</sup>		Unidentified Material			D	N										
Structure		Concrete (precast)			C	Y		100			%	V0000	Non-Asbestos		None	
Wall		Masonry			A	Y		100			%	V0000	Non-Asbestos		None	

1 - Concealed by column enclosure

**Client: Hamilton-Wentworth Catholic District Sch**  
**Location: #1005 : Main Office**  
**Survey Date: 2018-07-13**

**Site: Elementary**  
**Floor: 1**

**Building Name: St. Michael**  
**Room #:**  
**Last Re-Assessment: 2023-03-30**

**Area (sqft): 0**

ASBESTOS																
System	Component	Material	Item	Covering	A*	V*	AP*	Good	Fair	Poor	Unit	Sample	Asbestos Type	Amount	Hazard	Friable
Ceiling		Ceiling Tiles (lay-in), 2' x 4' short fissure random pinhole (2005)			C	Y		100			%	V0000	Non-Asbestos		None	
Ceiling		Plaster			C	Y		100			%	S0002C	None Detected	N.D.	None	
Floor		Wood, Laminate			A	Y		100			%	V0000	Non-Asbestos		None	
Floor		Carpet			A	Y		100			%	V0000	Non-Asbestos		None	
Piping		Fibreglass			C	N		100			%	V0000	Non-Asbestos		None	
Wall		Drywall and joint compound			A	Y		100			%	V0003	None Detected	N.D.	None	
Wall		Masonry			A	Y		100			%	V0000	Non-Asbestos		None	



**Client:** Hamilton-Wentworth Catholic District Sch  
**Location:** #1006 : Principals Office  
**Survey Date:** 2018-07-13

**Site:** Elementary  
**Floor:** 1

**Building Name:** St. Michael  
**Room #:**  
**Last Re-Assessment:** 2023-03-30

**Area (sqft):** 0

ASBESTOS																
System	Component	Material	Item	Covering	A*	V*	AP*	Good	Fair	Poor	Unit	Sample	Asbestos Type	Amount	Hazard	Friable
Ceiling		Ceiling Tiles (lay-in), 2x4 short fissure random pinhole (2005)			A	Y		100			%	V0000	Non-Asbestos		None	
Ceiling		Plaster			C	Y		100			%	V0002	None Detected	N.D.	None	
Ceiling		Masonry			A	Y		100			%	V0000	Non-Asbestos		None	
Floor		Carpet			A	Y		100			%					
Piping		Fibreglass			C	N		100			%	V0000	Non-Asbestos		None	
Wall		Drywall and joint compound			A	Y		100			%	V0003	None Detected	N.D.	None	
Wall		Masonry			A	Y		100			%	V0000	Non-Asbestos		None	

**Client:** Hamilton-Wentworth Catholic District Sch  
**Location:** #1007 : Front Entrance  
**Survey Date:** 2018-07-13

**Site:** Elementary  
**Floor:** 1

**Building Name:** St. Michael  
**Room #:**  
**Last Re-Assessment:** 2023-03-30

**Area (sqft):** 0

**ASBESTOS**

System	Component	Material	Item	Covering	A*	V*	AP*	Good	Fair	Poor	Unit	Sample	Asbestos Type	Amount	Hazard	Friable
Floor		Terrazzo			A	Y		100			%					
Structure		Concrete (precast)			C	Y		100			%	V0000	Non-Asbestos		None	
Wall		Ceramic Tiles			A	Y		100			%	V0000	Non-Asbestos		None	

**Client:** Hamilton-Wentworth Catholic District Sch  
**Location:** #1008 : Corridor  
**Survey Date:** 2018-07-13

**Site:** Elementary  
**Floor:** 1

**Building Name:** St. Michael  
**Room #:**  
**Last Re-Assessment:** 2023-03-30

**Area (sqft):** 0

**ASBESTOS**

System	Component	Material	Item	Covering	A*	V*	AP*	Good	Fair	Poor	Unit	Sample	Asbestos Type	Amount	Hazard	Friable
Ceiling		Ceiling Tiles (lay-in), 2' x 4' pinhole and round flecks (2012)			C	Y		100			%	V0000	Non-Asbestos		None	
Floor		Terrazzo			A	Y		100			%					
Piping		Fibreglass			C	N		100			%	V0000	Non-Asbestos		None	
Wall		Wood, Panels			A	Y		100			%	V0000	Non-Asbestos		None	
Wall		Masonry			A	Y		100			%	V0000	Non-Asbestos		None	

**Client: Hamilton-Wentworth Catholic District Sch**  
**Location: #1009 : Girls Washroom**  
**Survey Date: 2018-07-13**

**Site: Elementary**  
**Floor: 1**

**Building Name: St. Michael**  
**Room #:**  
**Last Re-Assessment: 2023-03-30**

**Area (sqft): 0**

ASBESTOS																
System	Component	Material	Item	Covering	A*	V*	AP*	Good	Fair	Poor	Unit	Sample	Asbestos Type	Amount	Hazard	Friable
Ceiling		Plaster			C	Y		100			%	V0002	None Detected	N.D.	None	
Floor		Vinyl Floor Tile and Mastic, 12x12 beige with orange flecks			A	Y		100(7)			%	V9500	Presumed Asbestos		Presumed Asbestos	NF
Wall		Masonry			A	Y		100			%	V0000	Non-Asbestos		None	

**Client: Hamilton-Wentworth Catholic District Sch**  
**Location: #1010 : Staff Room**  
**Survey Date: 2018-07-13**

**Site: Elementary**  
**Floor: 1**

**Building Name: St. Michael**  
**Room #:**  
**Last Re-Assessment: 2023-03-30**

**Area (sqft): 0**

ASBESTOS																
System	Component	Material	Item	Covering	A*	V*	AP*	Good	Fair	Poor	Unit	Sample	Asbestos Type	Amount	Hazard	Friable
Ceiling		Ceiling Tiles (lay-in), 2' x 4' pinhole and round flecks (2012)			C	Y		100			%	V0000	Non-Asbestos		None	
Ceiling		Plaster			C	Y						V0002	None Detected	N.D.	None	
Floor		Vinyl Floor Tile and Mastic, 12x12 salmon with white flecks			A	Y		100(7)			%	V9500	Presumed Asbestos		Presumed Asbestos	NF
Piping		Fibreglass			C	N										
Wall		Plaster			A	Y		100			%	V0002	None Detected	N.D.	None	
Wall		Masonry			A	Y		100			%	V0000	Non-Asbestos		None	

**Client:** Hamilton-Wentworth Catholic District Sch  
**Location:** #1011 : Classroom 3  
**Survey Date:** 2018-07-13

**Site:** Elementary  
**Floor:** 1

**Building Name:** St. Michael  
**Room #:**  
**Last Re-Assessment:** 2023-03-30

**Area (sqft):** 0

ASBESTOS																
System	Component	Material	Item	Covering	A*	V*	AP*	Good	Fair	Poor	Unit	Sample	Asbestos Type	Amount	Hazard	Friable
Ceiling		Ceiling Tiles (lay-in), 2x4 pinhole and small fleck (new)			C	Y		100			%	V0000	Non-Asbestos		None	
Floor		Laminate			A	Y										
Floor		Mastic			D	N		100(7)			%	V9500	Presumed Asbestos		Presumed Asbestos	NF
Structure		Concrete (precast)			C	Y		100			%	V0000	Non-Asbestos		None	
Wall		Drywall and joint compound, new			A	Y		100			%	V0000	Non-Asbestos		None	
Wall		Masonry			A	Y		100			%	V0000	Non-Asbestos		None	

**Client:** Hamilton-Wentworth Catholic District Sch  
**Location:** #1012 : Classroom 1  
**Survey Date:** 2018-07-13

**Site:** Elementary  
**Floor:** 1

**Building Name:** St. Michael  
**Room #:**  
**Last Re-Assessment:** 2023-03-30

**Area (sqft):** 0

ASBESTOS																
System	Component	Material	Item	Covering	A*	V*	AP*	Good	Fair	Poor	Unit	Sample	Asbestos Type	Amount	Hazard	Friable
Ceiling		Ceiling Tiles (lay-in)			C	Y		100			%	V0000	Non-Asbestos		None	
Floor		Mastic			D	N		100(7)			%	V9500	Presumed Asbestos		Presumed Asbestos	NF
Floor		Vinyl Floor Tile (No Mastic), 12" x 12" beige with brown fleck (2015)			A	Y		100			%	V0000	Non-Asbestos		None	
Structure		Concrete (precast)			C	Y		100			%	V0000	Non-Asbestos		None	
Wall <sup>1</sup>		Drywall and joint compound			A	Y		100			%	V0003	None Detected	N.D.	None	
Wall		Masonry			A	Y		100			%	V0000	Non-Asbestos		None	

1 - In washroom

**Client: Hamilton-Wentworth Catholic District Sch**  
**Location: #1013 : Storage**  
**Survey Date: 2018-07-13**

**Site: Elementary**  
**Floor: 1**

**Building Name: St. Michael**  
**Room #:**  
**Last Re-Assessment: 2023-03-30**

**Area (sqft): 0**

ASBESTOS																
System	Component	Material	Item	Covering	A*	V*	AP*	Good	Fair	Poor	Unit	Sample	Asbestos Type	Amount	Hazard	Friable
Ceiling		Ceiling Tiles (lay-in), 2' x 4' long fissure random pinhole (2012)			A	Y		100			%	V0000	Non-Asbestos		None	
Ceiling		Ceiling Tiles (lay-in), 2' x 4' short fissure random pinhole (2005)			C	Y		100			%	V0000	Non-Asbestos		None	
Floor		Mastic			D	N		100(7)			%	V9500	Presumed Asbestos		Presumed Asbestos	NF
Floor		Vinyl Floor Tile (No Mastic), 12" x 12" beige with brown fleck (2015)			A	Y		100			%	V0000	Non-Asbestos		None	
Piping		Fibreglass			A	Y		100			%	V0000	Non-Asbestos		None	
Wall		Masonry			A	Y		100			%	V0000	Non-Asbestos		None	

**Client:** Hamilton-Wentworth Catholic District Sch  
**Location:** #1014 : Stairwell 2  
**Survey Date:** 2018-07-13

**Site:** Elementary  
**Floor:** 1

**Building Name:** St. Michael  
**Room #:**  
**Last Re-Assessment:** 2023-03-30

**Area (sqft):** 0

ASBESTOS																
System	Component	Material	Item	Covering	A*	V*	AP*	Good	Fair	Poor	Unit	Sample	Asbestos Type	Amount	Hazard	Friable
Ceiling		Ceiling Tiles (lay-in), 2' x 4' textured pinhole (fiberglass)			C	Y		100				V0000	Non-Asbestos		None	
Floor		Terrazzo			A	Y		100			%	S0013ABC	Chrysotile	<0.5%	None	
Wall		Plaster			A	Y		100			%	V0002	None Detected	N.D.	None	
Wall		Masonry			A	Y		100			%	V0000	Non-Asbestos		None	

**Client:** Hamilton-Wentworth Catholic District Sch  
**Location:** #1015 : Classroom 2  
**Survey Date:** 2018-07-13

**Site:** Elementary  
**Floor:** 1

**Building Name:** St. Michael  
**Room #:**  
**Last Re-Assessment:** 2023-03-30

**Area (sqft):** 0

ASBESTOS																
System	Component	Material	Item	Covering	A*	V*	AP*	Good	Fair	Poor	Unit	Sample	Asbestos Type	Amount	Hazard	Friable
Ceiling <sup>1</sup>		Plaster			C	Y		100			%	S0002D	None Detected	N.D.	None	
Floor		Terrazzo			A	Y										
Floor		Mastic			D	N		100(7)			%	V9500	Presumed Asbestos		Presumed Asbestos	NF
Floor		Vinyl Floor Tile (No Mastic), 12" x 12" beige with brown fleck (2015)			A	Y		100			%	V0000	Non-Asbestos		None	
Piping	Sanitary Drain	Metal		Not Insulated	B	N										
Structure		Concrete (precast)			C	Y		100			%	V0000	Non-Asbestos		None	
Wall		Masonry			A	Y		100			%	V0000	Non-Asbestos		None	
Wall	Column	Drywall and joint compound			A	Y		100			%	S0003C	None Detected	N.D.	None	

1 - Washroom

**Client:** Hamilton-Wentworth Catholic District Sch  
**Location:** #1016 : Classroom 4  
**Survey Date:** 2018-07-13

**Site:** Elementary  
**Floor:** 1

**Building Name:** St. Michael  
**Room #:**  
**Last Re-Assessment:** 2023-03-30

**Area (sqft):** 0

ASBESTOS																
System	Component	Material	Item	Covering	A*	V*	AP*	Good	Fair	Poor	Unit	Sample	Asbestos Type	Amount	Hazard	Friable
Floor		Terrazzo			A	Y										
Floor		Mastic			A	Y		100(7)			%	V9500	Presumed Asbestos		Presumed Asbestos	NF
Floor		Vinyl Floor Tile (No Mastic), 12" x 12" beige with brown fleck (2015)			A	Y		100				V0000	Non-Asbestos		None	
Other <sup>1</sup>	Electric Light Fixture	Paper			C	Y		1			EA	V9500	[None]		[Abated]	
Structure		Concrete (precast)			C	Y		100			%	V0000	Non-Asbestos		None	
Wall		Masonry			A	Y		100			%	V0000	Non-Asbestos		None	
Wall	Column	Drywall and joint compound			A	Y		100			%	V0003	None Detected	N.D.	None	

1 - In washroom



**Client: Hamilton-Wentworth Catholic District Sch**  
**Location: #1017 : Boiler Room**  
**Survey Date: 2018-07-13**

**Site: Elementary**  
**Floor: 1**

**Building Name: St. Michael**  
**Room #:**  
**Last Re-Assessment: 2023-03-30**

**Area (sqft): 0**

ASBESTOS																
System	Component	Material	Item	Covering	A*	V*	AP*	Good	Fair	Poor	Unit	Sample	Asbestos Type	Amount	Hazard	Friable
Floor		Concrete (poured)			A	Y		100			%	V0000	Non-Asbestos		None	
Piping		Fibreglass			C	Y		100			%	V0000	Non-Asbestos		None	
Structure		Concrete (precast)			C	Y		100			%	V0000	Non-Asbestos		None	
Wall		Wood, Panels			A	Y		100			%	V0000	Non-Asbestos		None	
Wall		Masonry			A	Y		100			%	V0000	Non-Asbestos		None	

**Client: Hamilton-Wentworth Catholic District Sch**  
**Location: #1018 : Boys Washroom**  
**Survey Date: 2018-07-13**

**Site: Elementary**  
**Floor: 1**

**Building Name: St. Michael**  
**Room #:**  
**Last Re-Assessment: 2023-03-30**

**Area (sqft): 0**

ASBESTOS																
System	Component	Material	Item	Covering	A*	V*	AP*	Good	Fair	Poor	Unit	Sample	Asbestos Type	Amount	Hazard	Friable
Ceiling		Plaster			C	Y		100			%	S0002A	None Detected	N.D.	None	
Floor		Terrazzo			A	Y		100			%					
Piping		Fibreglass			C	N		100			%	V0000	Non-Asbestos		None	
Piping		Parging Cement	Fitting		C	N		2(7)			EA	V0004	Chrysotile	50-75%	Confirmed Asbestos	F
Piping		Sweatwrap			C	N						V0000	Non-Asbestos		None	
Wall		Wood, Panels			A	Y		100			%	V0000	Non-Asbestos		None	
Wall		Masonry			A	Y		100			%	V0000	Non-Asbestos		None	

**Client: Hamilton-Wentworth Catholic District Sch**  
**Location: #1019 : Special Needs Washroom**  
**Survey Date: 2018-07-13**

**Site: Elementary**  
**Floor: 1**

**Building Name: St. Michael**  
**Room #:**  
**Last Re-Assessment: 2023-03-30**

**Area (sqft): 0**

ASBESTOS																
System	Component	Material	Item	Covering	A*	V*	AP*	Good	Fair	Poor	Unit	Sample	Asbestos Type	Amount	Hazard	Friable
Ceiling		Ceiling Tiles (lay-in), 2' x 4' smooth gypsum board			C	Y		100			%	V0000	Non-Asbestos		None	
Floor		Terrazzo			A	Y		100			%					
Piping		Fibreglass			C	Y		100			%	V0000	Non-Asbestos		None	
Wall		Plaster			A	Y		100			%	V0002	None Detected	N.D.	None	
Wall		Masonry			A	Y		100			%	V0000	Non-Asbestos		None	

**Client: Hamilton-Wentworth Catholic District Sch**  
**Location: #1020 : Corridor**  
**Survey Date: 2018-07-13**

**Site: Elementary**  
**Floor: 1**

**Building Name: St. Michael**  
**Room #:**  
**Last Re-Assessment: 2023-03-30**

**Area (sqft): 0**

ASBESTOS																
System	Component	Material	Item	Covering	A*	V*	AP*	Good	Fair	Poor	Unit	Sample	Asbestos Type	Amount	Hazard	Friable
Ceiling		Ceiling Tiles (lay-in), 2' x 4' short fissure random pinhole (2005)			C	Y		100			%	V0000	Non-Asbestos		None	
Floor		Terrazzo			A	Y		100			%					
Piping		Fibreglass			C	N		100			%	V0000	Non-Asbestos		None	
Wall		Wood, Panels			A	Y		100			%	V0000	Non-Asbestos		None	
Wall		Masonry			A	Y		100			%	V0000	Non-Asbestos		None	

**Client:** Hamilton-Wentworth Catholic District Sch  
**Location:** #1021 : Back Room  
**Survey Date:** 2018-07-13

**Site:** Elementary  
**Floor:** 1

**Building Name:** St. Michael  
**Room #:**  
**Last Re-Assessment:** 2023-03-30

**Area (sqft):** 0

ASBESTOS																
System	Component	Material	Item	Covering	A*	V*	AP*	Good	Fair	Poor	Unit	Sample	Asbestos Type	Amount	Hazard	Friable
Ceiling		Ceiling Tiles (lay-in), 2' x 4' long fissure random pinhole (2012)			C	Y		100			%	V0000	Non-Asbestos		None	
Floor		Terrazzo			A	Y		100			%					
Piping		Fibreglass			C	N		100			%	V0000	Non-Asbestos		None	
Wall		Plaster			A	Y		100			%	V0002	None Detected	N.D.	None	
Wall		Masonry			A	Y		100			%	V0000	Non-Asbestos		None	

**Client:** Hamilton-Wentworth Catholic District Sch  
**Location:** #1022 : Kitchen  
**Survey Date:** 2018-07-13

**Site:** Elementary  
**Floor:** 1

**Building Name:** St. Michael  
**Room #:**  
**Last Re-Assessment:** 2023-03-30

**Area (sqft):** 0

ASBESTOS																
System	Component	Material	Item	Covering	A*	V*	AP*	Good	Fair	Poor	Unit	Sample	Asbestos Type	Amount	Hazard	Friable
Ceiling	Bulkhead	Drywall and joint compound			C	Y		100			%	V0003	None Detected	N.D.	None	
Floor		Terrazzo			A	Y		100			%					
Piping		Not Insulated			A	Y		100			%	V0000	Non-Asbestos		None	
Structure		Concrete (precast)			C	Y		100			%	V0000	Non-Asbestos		None	
Wall		Drywall and joint compound			A	Y		100			%	S0003A	None Detected	N.D.	None	
Wall		Plaster			A	Y		100			%	S0002B	None Detected	N.D.	None	
Wall		Masonry			A	Y		100			%	V0000	Non-Asbestos		None	

**Client:** Hamilton-Wentworth Catholic District Sch  
**Location:** #1023 : Electrical Room  
**Survey Date:** 2018-07-13

**Site:** Elementary  
**Floor:** 1

**Building Name:** St. Michael  
**Room #:**  
**Last Re-Assessment:** 2023-03-30

**Area (sqft):** 0

ASBESTOS																
System	Component	Material	Item	Covering	A*	V*	AP*	Good	Fair	Poor	Unit	Sample	Asbestos Type	Amount	Hazard	Friable
Floor		Mastic			D	N		100(7)			%	V9500	Presumed Asbestos		Presumed Asbestos	NF
Floor		Vinyl Floor Tile (No Mastic), 12" x 12" beige with white fleck (2006)			A	Y		100			%	V0000	Non-Asbestos		None	
Structure		Concrete (precast)			C	Y		100			%	V0000	Non-Asbestos		None	
Wall		Drywall and joint compound			A	Y		100			%	V0003	None Detected	N.D.	None	
Wall		Plaster			A	Y					%	V0002	None Detected	N.D.	None	
Wall		Masonry			A	Y		100			%	V0000	Non-Asbestos		None	

**Client:** Hamilton-Wentworth Catholic District Sch  
**Location:** #1024 : Library Storage  
**Survey Date:** 2018-07-13

**Site:** Elementary  
**Floor:** 1

**Building Name:** St. Michael  
**Room #:**  
**Last Re-Assessment:** 2023-03-30

**Area (sqft):** 0

ASBESTOS																
System	Component	Material	Item	Covering	A*	V*	AP*	Good	Fair	Poor	Unit	Sample	Asbestos Type	Amount	Hazard	Friable
Ceiling		Ceiling Tiles (lay-in), 2' x 4' short fissure random pinhole (2005)			C	Y		100			%	V0000	Non-Asbestos		None	
Floor		Mastic			D	N		100(7)			%	V9500	Presumed Asbestos		Presumed Asbestos	NF
Floor		Vinyl Floor Tile (No Mastic), 12" x 12" beige with white fleck (2006)			A	Y		100			%	V0000	Non-Asbestos		None	
Piping		Fibreglass			C	Y		100			%	V0000	Non-Asbestos		None	
Wall		Drywall and joint compound			A	Y		100			%	V0003	None Detected	N.D.	None	
Wall		Masonry			A	Y		100			%	V0000	Non-Asbestos		None	

**Client: Hamilton-Wentworth Catholic District Sch**  
**Location: #1025 : Corridor**  
**Survey Date: 2018-07-13**

**Site: Elementary**  
**Floor: 1**

**Building Name: St. Michael**  
**Room #:**  
**Last Re-Assessment: 2023-03-30**

**Area (sqft): 0**

ASBESTOS																
System	Component	Material	Item	Covering	A*	V*	AP*	Good	Fair	Poor	Unit	Sample	Asbestos Type	Amount	Hazard	Friable
Ceiling		Ceiling Tiles (lay-in), 2' x 4' short fissure random pinhole (2005)			C	Y		100			%	V0000	Non-Asbestos		None	
Floor		Ceramic Tiles			A	Y		100			%	V0000	Non-Asbestos		None	
Wall		Masonry			A	Y		100			%	V0000	Non-Asbestos		None	

**Client: Hamilton-Wentworth Catholic District Sch**  
**Location: #1026 : Storage**  
**Survey Date: 2018-07-13**

**Site: Elementary**  
**Floor: 1**

**Building Name: St. Michael**  
**Room #:**  
**Last Re-Assessment: 2023-03-30**

**Area (sqft): 0**

ASBESTOS																
System	Component	Material	Item	Covering	A*	V*	AP*	Good	Fair	Poor	Unit	Sample	Asbestos Type	Amount	Hazard	Friable
Ceiling		Ceiling Tiles (lay-in), 2' x 4' short fissure random pinhole (2005)			C	Y		100			%	V0000	Non-Asbestos		None	
Floor		Mastic			D	N		100(7)			%	V9500	Presumed Asbestos		Presumed Asbestos	NF
Floor		Vinyl Floor Tile (No Mastic), 12" x 12" beige with white fleck (2006)			A	Y		100			%	V0000	Non-Asbestos		None	
Piping		Fibreglass			C	Y		100			%	V0000	Non-Asbestos		None	
Wall		Drywall and joint compound			A	Y		100			%	V0003	None Detected	N.D.	None	
Wall		Masonry			A	Y		100			%	V0000	Non-Asbestos		None	

**Client:** Hamilton-Wentworth Catholic District Sch  
**Location:** #1027 : Corridor  
**Survey Date:** 2018-07-13

**Site:** Elementary  
**Floor:** 1

**Building Name:** St. Michael  
**Room #:**  
**Last Re-Assessment:** 2023-03-30

**Area (sqft):** 0

ASBESTOS																
System	Component	Material	Item	Covering	A*	V*	AP*	Good	Fair	Poor	Unit	Sample	Asbestos Type	Amount	Hazard	Friable
Ceiling		Ceiling Tiles (lay-in), 2' x 4' long fissure random pinhole (2012)			C	Y		100			%	V0000	Non-Asbestos		None	
Floor		Ceramic Tiles			A	Y		100			%	V0000	Non-Asbestos		None	
Piping		Fibreglass		Polyvinyl chloride (PVC)	A	Y		100			%	V0000	Non-Asbestos		None	
Wall		Masonry			A	Y		100			%	V0000	Non-Asbestos		None	

**Client:** Hamilton-Wentworth Catholic District Sch  
**Location:** #1028 : Computer Lab  
**Survey Date:** 2018-07-13

**Site:** Elementary  
**Floor:** 1

**Building Name:** St. Michael  
**Room #:**  
**Last Re-Assessment:** 2023-03-30

**Area (sqft):** 0

ASBESTOS																
System	Component	Material	Item	Covering	A*	V*	AP*	Good	Fair	Poor	Unit	Sample	Asbestos Type	Amount	Hazard	Friable
Floor		Mastic			A	Y		100(7)			%	V9500	Presumed Asbestos		Presumed Asbestos	NF
Floor		Vinyl Floor Tile (No Mastic), 12" x 12" beige with white fleck			A	Y		100			%	V0000	Non-Asbestos		None	
Piping		Fibreglass			A	Y		100			%	V0000	Non-Asbestos		None	
Wall		Drywall and joint compound			A	Y		100			%	V0003	None Detected	N.D.	None	
Wall		Masonry			A	Y		100			%	V0000	Non-Asbestos		None	

**Client:** Hamilton-Wentworth Catholic District Sch  
**Location:** #1029 : Corridor  
**Survey Date:** 2018-07-13

**Site:** Elementary  
**Floor:** 1

**Building Name:** St. Michael  
**Room #:**  
**Last Re-Assessment:** 2023-03-30

**Area (sqft):** 0

ASBESTOS																
System	Component	Material	Item	Covering	A*	V*	AP*	Good	Fair	Poor	Unit	Sample	Asbestos Type	Amount	Hazard	Friable
Ceiling		Ceiling Tiles (lay-in), 2' x 4' short fissure random pinhole (2005)			C	Y		100			%	V0000	Non-Asbestos		None	
Floor		Ceramic Tiles			A	Y		100			%	V0000	Non-Asbestos		None	
Piping		Fibreglass			C	Y		100			%	V0000	Non-Asbestos		None	
Wall		Masonry			A	Y		100			%	V0000	Non-Asbestos		None	

**Client:** Hamilton-Wentworth Catholic District Sch  
**Location:** #1030 : Gym Corridor  
**Survey Date:** 2018-07-13

**Site:** Elementary  
**Floor:** 1

**Building Name:** St. Michael  
**Room #:**  
**Last Re-Assessment:** 2023-03-30

**Area (sqft):** 0

ASBESTOS																
System	Component	Material	Item	Covering	A*	V*	AP*	Good	Fair	Poor	Unit	Sample	Asbestos Type	Amount	Hazard	Friable
Ceiling		Ceiling Tiles (lay-in), 2' x 4' long fissure random pinhole (2012)			C	Y		100			%	V0000	Non-Asbestos		None	
Floor		Ceramic Tiles, 12" x 12" beige with white fleck			A	Y		100			%					
Piping		Fibreglass			C	N		100			%	V0000	Non-Asbestos		None	
Structure					A	Y		100			%	V0000	Non-Asbestos		None	
Wall		Masonry			A	Y		100			%	V0000	Non-Asbestos		None	

**Client: Hamilton-Wentworth Catholic District Sch**  
**Location: #1031 : Boys Washroom**  
**Survey Date: 2018-07-13**

**Site: Elementary**  
**Floor: 1**

**Building Name: St. Michael**  
**Room #:**  
**Last Re-Assessment: 2023-03-30**

**Area (sqft): 0**

ASBESTOS																
System	Component	Material	Item	Covering	A*	V*	AP*	Good	Fair	Poor	Unit	Sample	Asbestos Type	Amount	Hazard	Friable
Ceiling		Ceiling Tiles (lay-in), 2' x 4' flat face (gypsum)			A	Y		100			%	V0000	Non-Asbestos		None	
Floor		Vinyl Floor Tile and Mastic, 12" x 12" beige with white fleck (2006)			A	Y		100			%	V0000	Non-Asbestos		None	
Piping		Fibreglass			C	Y		100			%	V0000	Non-Asbestos		None	
Wall		Masonry			A	Y		100			%	V0000	Non-Asbestos		None	

**Client: Hamilton-Wentworth Catholic District Sch**  
**Location: #1032 : Boys Shower**  
**Survey Date: 2018-07-13**

**Site: Elementary**  
**Floor: 1**

**Building Name: St. Michael**  
**Room #:**  
**Last Re-Assessment: 2023-03-30**

**Area (sqft): 0**

ASBESTOS																
System	Component	Material	Item	Covering	A*	V*	AP*	Good	Fair	Poor	Unit	Sample	Asbestos Type	Amount	Hazard	Friable
Ceiling		Drywall and joint compound			C	Y		100			%	V0000	Non-Asbestos		None	
Floor		Ceramic Tiles			A	Y		100			%	V0000	Non-Asbestos		None	
Wall		Masonry			A	Y		100			%	V0000	Non-Asbestos		None	
Wall		Ceramic Tiles			A	Y		100			%	V0000	Non-Asbestos		None	



**Client:** Hamilton-Wentworth Catholic District Sch  
**Location:** #1033 : Girls' Washroom  
**Survey Date:** 2018-07-13

**Site:** Elementary  
**Floor:** 1

**Building Name:** St. Michael  
**Room #:**  
**Last Re-Assessment:** 2023-03-30

**Area (sqft):** 0

ASBESTOS																
System	Component	Material	Item	Covering	A*	V*	AP*	Good	Fair	Poor	Unit	Sample	Asbestos Type	Amount	Hazard	Friable
Ceiling		Ceiling Tiles (lay-in), 2' x 4' flat face			C	Y		100			%	V0000	Non-Asbestos		None	
Floor		Vinyl Floor Tile and Mastic, 12" x 12" beige with white fleck (2006)			A	Y		100			%	V0000	Non-Asbestos		None	
Piping		Fibreglass			C	Y		100			%	V0000	Non-Asbestos		None	
Wall		Masonry			A	Y		100			%	V0000	Non-Asbestos		None	

**Client:** Hamilton-Wentworth Catholic District Sch  
**Location:** #1034 : Girls Shower  
**Survey Date:** 2018-07-13

**Site:** Elementary  
**Floor:** 1

**Building Name:** St. Michael  
**Room #:**  
**Last Re-Assessment:** 2023-03-30

**Area (sqft):** 0

ASBESTOS																
System	Component	Material	Item	Covering	A*	V*	AP*	Good	Fair	Poor	Unit	Sample	Asbestos Type	Amount	Hazard	Friable
Ceiling		Drywall and joint compound			C	Y		100			%	V0000	Non-Asbestos		None	
Floor		Ceramic Tiles			A	Y		100			%	V0000	Non-Asbestos		None	
Wall		Masonry			A	Y		100			%	V0000	Non-Asbestos		None	
Wall		Ceramic Tiles			A	Y		100			%	V0000	Non-Asbestos		None	

**Client: Hamilton-Wentworth Catholic District Sch**  
**Location: #1035 : Gym Kitchen**  
**Survey Date: 2018-07-13**

**Site: Elementary**  
**Floor: 1**

**Building Name: St. Michael**  
**Room #:**  
**Last Re-Assessment: 2023-03-30**

**Area (sqft): 0**

ASBESTOS																
System	Component	Material	Item	Covering	A*	V*	AP*	Good	Fair	Poor	Unit	Sample	Asbestos Type	Amount	Hazard	Friable
Ceiling		Drywall and joint compound			C	Y		100			%	V0000	Non-Asbestos		None	
Floor		Vinyl Floor Tile and Mastic, 12" x 12" beige with white fleck (2006)			A	Y		100			%	V0000	Non-Asbestos		None	
Wall		Masonry			A	Y		100			%	V0000	Non-Asbestos		None	

**Client: Hamilton-Wentworth Catholic District Sch**  
**Location: #1036 : Gym Storage**  
**Survey Date: 2018-07-13**

**Site: Elementary**  
**Floor: 1**

**Building Name: St. Michael**  
**Room #:**  
**Last Re-Assessment: 2023-03-30**

**Area (sqft): 0**

ASBESTOS																
System	Component	Material	Item	Covering	A*	V*	AP*	Good	Fair	Poor	Unit	Sample	Asbestos Type	Amount	Hazard	Friable
Floor		Vinyl Floor Tile (No Mastic), 12" x 12" grey with grey fleck (2006)			A	Y		100			%	V0000	Non-Asbestos		None	
Piping		Fibreglass			C	Y		100			%	V0000	Non-Asbestos		None	
Structure	Deck	Steel			A	Y		100			%	V0000	Non-Asbestos		None	
Wall	All	Masonry			A	Y		100			%	V0000	Non-Asbestos		None	

**Client: Hamilton-Wentworth Catholic District Sch**  
**Location: #1037 : Gymnasium**  
**Survey Date: 2018-07-13**

**Site: Elementary**  
**Floor: 1**

**Building Name: St. Michael**  
**Room #:**  
**Last Re-Assessment: 2023-03-30**

**Area (sqft): 0**

ASBESTOS																
System	Component	Material	Item	Covering	A*	V*	AP*	Good	Fair	Poor	Unit	Sample	Asbestos Type	Amount	Hazard	Friable
Floor		Vinyl Sheet Flooring, Faux wood (2006)			A	Y		100			%	V0000	Non-Asbestos		None	
Piping		Fibreglass			C	Y		100			%	V0000	Non-Asbestos		None	
Structure	Deck	Steel			C	Y		100			%	V0000	Non-Asbestos		None	
Wall		Masonry			A	Y		100			%	V0000	Non-Asbestos		None	

**Client: Hamilton-Wentworth Catholic District Sch**  
**Location: #1039 : Vice Principal Office**  
**Survey Date: 2018-07-13**

**Site: Elementary**  
**Floor: 1**

**Building Name: St. Michael**  
**Room #:**  
**Last Re-Assessment: 2023-03-30**

**Area (sqft): 0**

ASBESTOS																
System	Component	Material	Item	Covering	A*	V*	AP*	Good	Fair	Poor	Unit	Sample	Asbestos Type	Amount	Hazard	Friable
Ceiling		Ceiling Tiles (lay-in), 2' x 4' short fissure random pinhole (2005)			C	Y		100			%	V0000	Non-Asbestos		None	
Floor		Carpet			A	Y		100			%	V0000	Non-Asbestos		None	
Piping		Fibreglass			C	N		100			%	V0000	Non-Asbestos		None	
Structure		Concrete (precast)			C	Y		100			%	V0000	Non-Asbestos		None	
Wall		Drywall and joint compound			A	Y		100			%	V0003	None Detected	N.D.	None	
Wall		Masonry			A	Y		100			%	V0000	Non-Asbestos		None	

**Client:** Hamilton-Wentworth Catholic District Sch  
**Location:** #1040 : Library  
**Survey Date:** 2018-07-13

**Site:** Elementary  
**Floor:** 1

**Building Name:** St. Michael  
**Room #:**  
**Last Re-Assessment:** 2023-03-30

**Area (sqft):** 0

ASBESTOS																
System	Component	Material	Item	Covering	A*	V*	AP*	Good	Fair	Poor	Unit	Sample	Asbestos Type	Amount	Hazard	Friable
Ceiling		Ceiling Tiles (lay-in), 2 x 4' dense fleck (2005)			C	Y		100			%	V0000	Non-Asbestos		None	
Floor		Carpet			A	Y		100			%	V0000	Non-Asbestos		None	
Floor		Mastic			D	N		100(7)			%	V9500	Presumed Asbestos		Presumed Asbestos	NF
Floor		Vinyl Floor Tile (No Mastic), 12" x 12" beige with white fleck (2006)			A	Y		100			%	V0000	Non-Asbestos		None	
Wall		Drywall and joint compound			A	Y		100			%	S0003B	None Detected	N.D.	None	
Wall		Masonry			A	Y		100			%	V0000	Non-Asbestos		None	

**Client:** Hamilton-Wentworth Catholic District Sch  
**Location:** #1041 : Exterior - Original  
**Survey Date:** 2018-07-13

**Site:** Elementary  
**Floor:** 1

**Building Name:** St. Michael  
**Room #:**  
**Last Re-Assessment:** 2023-03-30

**Area (sqft):** 0

ASBESTOS																
System	Component	Material	Item	Covering	A*	V*	AP*	Good	Fair	Poor	Unit	Sample	Asbestos Type	Amount	Hazard	Friable
Ceiling	Soffit	Plaster, Textured	Exterior		C	Y		100(7)			%	S0001ABC	Chrysotile	0.5-5%	Confirmed Asbestos	PF
Wall		Unidentified Material, Bell and Spigot Packing			A	Y		100(7)			%	S0012ABC	Amosite	10-25%	Confirmed Asbestos	[PF]*
Wall		Caulking, Brown Caulking			A	Y		100			%	S0006ABC	None Detected	N.D.	None	
Wall		Caulking, Light Grey Caulking			A	Y		100			%	S0007ABC	None Detected	N.D.	None	
Wall		Caulking, Dark Grey Caulking			A	Y		100			%	S0008ABC	None Detected	N.D.	None	
Wall		Caulking, Beige Caulking			A	Y		100			%	S0009ABC	None Detected	N.D.	None	
Wall		Caulking, White Caulking			A	Y					LF	S0010ABC	Chrysotile	5-10%	Confirmed Asbestos	NF

**Client:** Hamilton-Wentworth Catholic District Sch  
**Location:** #1042 : Exterior - Addition  
**Survey Date:** 2018-07-13

**Site:** Elementary  
**Floor:** 1

**Building Name:** St. Michael  
**Room #:**  
**Last Re-Assessment:** 2023-03-30

**Area (sqft):** 0

ASBESTOS																
System	Component	Material	Item	Covering	A*	V*	AP*	Good	Fair	Poor	Unit	Sample	Asbestos Type	Amount	Hazard	Friable
Wall <sup>1</sup>		Caulking, White Caulking			A	Y		100			%	S0011ABC	None Detected	N.D.	None	

1 - Underneath Brown Caulking

**Client: Hamilton-Wentworth Catholic District Sch**  
**Location: #2000 : Classroom 14**  
**Survey Date: 2018-07-13**

**Site: Elementary**  
**Floor: 1**

**Building Name: St. Michael**  
**Room #:**  
**Last Re-Assessment: 2023-03-30**

**Area (sqft): 0**

ASBESTOS																
System	Component	Material	Item	Covering	A*	V*	AP*	Good	Fair	Poor	Unit	Sample	Asbestos Type	Amount	Hazard	Friable
Ceiling	Acoustic Tile	Ceiling Tiles (lay-in), Pinhole (24x48) pinhole			C	Y						V0000	Non-Asbestos		None	
Floor		Mastic		Vinyl Floor Tile	D	N		100(7)			%	V9500	Presumed Asbestos		Presumed Asbestos	NF
Floor		Vinyl Floor Tile (No Mastic), 12" x 12" grey dense flecks (installed 2021)			A	Y		100			%	V0000	Non-Asbestos		None	
Structure		Concrete (precast)			C	Y		100			%	V0000	Non-Asbestos		None	
Wall		Masonry			A	Y		100			%	V0000	Non-Asbestos		None	

**Client: Hamilton-Wentworth Catholic District Sch**  
**Location: #2001 : Classroom 12**  
**Survey Date: 2018-07-13**

**Site: Elementary**  
**Floor: 1**

**Building Name: St. Michael**  
**Room #:**  
**Last Re-Assessment: 2023-03-30**

**Area (sqft): 0**

ASBESTOS																
System	Component	Material	Item	Covering	A*	V*	AP*	Good	Fair	Poor	Unit	Sample	Asbestos Type	Amount	Hazard	Friable
Floor		Vinyl Floor Tile and Mastic, 12x12 beige with yellow flecks			A	Y		100(7)			%	V9500	Presumed Asbestos		Presumed Asbestos	NF
Floor		Vinyl Floor Tile and Mastic, 12x12 salmon with brown streaks			A	Y		100(7)			%	V9500	Presumed Asbestos		Presumed Asbestos	NF
Floor <sup>1</sup>		Vinyl Sheet Flooring, Off-white with dark flecks			A	Y		10(7)			SF	V9500	Presumed Asbestos		Presumed Asbestos	PF
Structure		Concrete (precast)			C	Y		100			%	V0000	Non-Asbestos		None	
Wall		Masonry			A	Y		100			%	V0000	Non-Asbestos		None	

1 - On low shelf/platform

**Client:** Hamilton-Wentworth Catholic District Sch  
**Location:** #2002 : Stairwell  
**Survey Date:** 2018-07-13

**Site:** Elementary  
**Floor:** 1

**Building Name:** St. Michael  
**Room #:**  
**Last Re-Assessment:** 2023-03-30

**Area (sqft):** 0

ASBESTOS																
System	Component	Material	Item	Covering	A*	V*	AP*	Good	Fair	Poor	Unit	Sample	Asbestos Type	Amount	Hazard	Friable
Floor		Terrazzo			A	Y						V0013	Chrysotile	<0.5%	None	
Piping		Not Insulated			A	Y										
Structure		Concrete (precast)			C	Y		100			%	V0000	Non-Asbestos		None	
Wall		Plaster, above door			A	Y		100			%	S0002F	None Detected	N.D.	None	
Wall		Masonry			A	Y		100			%	V0000	Non-Asbestos		None	

**Client:** Hamilton-Wentworth Catholic District Sch  
**Location:** #2003 : Classroom 15  
**Survey Date:** 2018-07-13

**Site:** Elementary  
**Floor:** 1

**Building Name:** St. Michael  
**Room #:**  
**Last Re-Assessment:** 2023-03-30

**Area (sqft):** 0

ASBESTOS																
System	Component	Material	Item	Covering	A*	V*	AP*	Good	Fair	Poor	Unit	Sample	Asbestos Type	Amount	Hazard	Friable
Floor		Mastic			D	N		100(7)			%	V9500	Presumed Asbestos		Presumed Asbestos	NF
Floor		Vinyl Floor Tile (No Mastic), 12" x 12" beige with brown fleck (2006)			A	Y		100			%	V0000	Non-Asbestos		None	
Piping		Unidentified Material			D	N										
Structure		Concrete (precast)			C	Y		100			%	V0000	Non-Asbestos		None	
Wall		Masonry			A	Y						V0000	Non-Asbestos		None	

**Client: Hamilton-Wentworth Catholic District Sch**  
**Location: #2004 : Classroom 13**  
**Survey Date: 2018-07-13**

**Site: Elementary**  
**Floor: 1**

**Building Name: St. Michael**  
**Room #:**  
**Last Re-Assessment: 2023-03-30**

**Area (sqft): 0**

ASBESTOS																
System	Component	Material	Item	Covering	A*	V*	AP*	Good	Fair	Poor	Unit	Sample	Asbestos Type	Amount	Hazard	Friable
Floor		Vinyl Floor Tile and Mastic, 12x12 beige with yellow flecks			A	Y		100(7)			%	V9500	Presumed Asbestos		Presumed Asbestos	NF
Floor		Vinyl Floor Tile and Mastic, 12x12 salmon with brown streaks			A	Y		100(7)			%	V9500	Presumed Asbestos		Presumed Asbestos	NF
Structure		Concrete (precast)			C	Y						V0000	Non-Asbestos		None	
Wall		Masonry			A	Y		100			%	V0000	Non-Asbestos		None	

**Client: Hamilton-Wentworth Catholic District Sch**  
**Location: #2005 : Corridor**  
**Survey Date: 2018-07-13**

**Site: Elementary**  
**Floor: 1**

**Building Name: St. Michael**  
**Room #:**  
**Last Re-Assessment: 2023-03-30**

**Area (sqft): 0**

ASBESTOS																
System	Component	Material	Item	Covering	A*	V*	AP*	Good	Fair	Poor	Unit	Sample	Asbestos Type	Amount	Hazard	Friable
Ceiling		Ceiling Tiles (lay-in), Long			C	Y		100			%	V0000	Non-Asbestos		None	
Ceiling		Ceiling Tiles (lay-in), 2' x 4' textured pinhole			C	Y		100			%	V0000	Non-Asbestos		None	
Floor		Terrazzo			A	Y		100			%					
Piping	Rain Water Leader	Sweatwrap			C	N		5			LF	S0005ABC	None Detected	N.D.	None	
Piping	Rain Water Leader	Horsehair	Fitting		C	N										
Wall		Masonry			A	Y		100			%	V0000	Non-Asbestos		None	
Wall		Ceramic Tiles			A	Y		100			%	V0000	Non-Asbestos		None	



**Client:** Hamilton-Wentworth Catholic District Sch  
**Location:** #2006 : Corridor  
**Survey Date:** 2018-07-13

**Site:** Elementary  
**Floor:** 1

**Building Name:** St. Michael  
**Room #:**  
**Last Re-Assessment:** 2023-03-30

**Area (sqft):** 0

ASBESTOS																
System	Component	Material	Item	Covering	A*	V*	AP*	Good	Fair	Poor	Unit	Sample	Asbestos Type	Amount	Hazard	Friable
Ceiling		Ceiling Tiles (lay-in), 2' x 4' long			C	Y		100			%	V0000	Non-Asbestos		None	
Ceiling		Ceiling Tiles (lay-in), 2' x 4' textured pinhole			C	Y		100			%	V0000	Non-Asbestos		None	
Floor		Terrazzo			A	Y		100			%					
Wall		Masonry			A	Y		100			%	V0000	Non-Asbestos		None	
Wall		Ceramic Tiles			A	Y		100			%	V0000	Non-Asbestos		None	

**Client:** Hamilton-Wentworth Catholic District Sch  
**Location:** #2007 : Stairwell  
**Survey Date:** 2018-07-13

**Site:** Elementary  
**Floor:** 1

**Building Name:** St. Michael  
**Room #:**  
**Last Re-Assessment:** 2023-03-30

**Area (sqft):** 0

ASBESTOS																
System	Component	Material	Item	Covering	A*	V*	AP*	Good	Fair	Poor	Unit	Sample	Asbestos Type	Amount	Hazard	Friable
Floor		Terrazzo			A	Y						V0013	Chrysotile	<0.5%	None	
Structure		Concrete (precast)			C	Y		100			%	V0000	Non-Asbestos		None	
Wall		Ceramic Tiles			A	Y		100			%	V0000	Non-Asbestos		None	
Wall		Glass			A	Y										

**Client:** Hamilton-Wentworth Catholic District Sch  
**Location:** #2008 : Boys Washroom  
**Survey Date:** 2018-07-13

**Site:** Elementary  
**Floor:** 1

**Building Name:** St. Michael  
**Room #:**  
**Last Re-Assessment:** 2023-03-30

**Area (sqft):** 0

ASBESTOS																
System	Component	Material	Item	Covering	A*	V*	AP*	Good	Fair	Poor	Unit	Sample	Asbestos Type	Amount	Hazard	Friable
Ceiling		Plaster			C	Y		100			%	S0002G	None Detected	N.D.	None	
Floor		Terrazzo			A	Y		100			%					
Structure	Not Accessible	no access above solid ceiling			D	N										
Wall <sup>1</sup>		Wood			A	Y		100			%	V0000	Non-Asbestos		None	
Wall		Masonry			A	Y		100			%	V0000	Non-Asbestos		None	

1 - wood panel

**Client:** Hamilton-Wentworth Catholic District Sch  
**Location:** #2009 : French Resource  
**Survey Date:** 2018-07-13

**Site:** Elementary  
**Floor:** 1

**Building Name:** St. Michael  
**Room #:**  
**Last Re-Assessment:** 2023-03-30

**Area (sqft):** 0

ASBESTOS																
System	Component	Material	Item	Covering	A*	V*	AP*	Good	Fair	Poor	Unit	Sample	Asbestos Type	Amount	Hazard	Friable
Floor		Laminate			A	Y		100			%					
Floor		Mastic			D	N		100(7)			%	V9500	Presumed Asbestos		Presumed Asbestos	NF
Structure		Concrete (precast)			C	Y		100			%					
Wall		Masonry			A	Y		100			%	V0000	Non-Asbestos		None	

**Client:** Hamilton-Wentworth Catholic District Sch  
**Location:** #2010 : Staff Room  
**Survey Date:** 2018-07-13

**Site:** Elementary  
**Floor:** 1

**Building Name:** St. Michael  
**Room #:**  
**Last Re-Assessment:** 2023-03-30

**Area (sqft):** 0

ASBESTOS																
System	Component	Material	Item	Covering	A*	V*	AP*	Good	Fair	Poor	Unit	Sample	Asbestos Type	Amount	Hazard	Friable
Floor		Laminate			A	Y		100			%					
Floor		Mastic		Laminate	D	N		100(7)			%	V9500	Presumed Asbestos		Presumed Asbestos	NF
Structure		Concrete (precast)			C	Y		100			%	V0000	Non-Asbestos		None	
Wall		Drywall and joint compound, new			A	Y		100			%	V0000	Non-Asbestos		None	
Wall		Masonry			A	Y		100			%	V0000	Non-Asbestos		None	

**Client:** Hamilton-Wentworth Catholic District Sch  
**Location:** #2011 : Staff Washroom  
**Survey Date:** 2018-07-13

**Site:** Elementary  
**Floor:** 1

**Building Name:** St. Michael  
**Room #:**  
**Last Re-Assessment:** 2023-03-30

**Area (sqft):** 0

ASBESTOS																
System	Component	Material	Item	Covering	A*	V*	AP*	Good	Fair	Poor	Unit	Sample	Asbestos Type	Amount	Hazard	Friable
Ceiling		Plaster			A	Y		100			%	V0002	None Detected	N.D.	None	
Floor		Terrazzo			A	Y		100			%					
Structure	Not Accessible	no access above solid ceiling			D	N										
Wall		Masonry			A	Y		100			%	V0000	Non-Asbestos		None	

**Client: Hamilton-Wentworth Catholic District Sch**  
**Location: #2012 : Womans Staff Washroom**  
**Survey Date: 2018-07-13**

**Site: Elementary**  
**Floor: 1**

**Building Name: St. Michael**  
**Room #:**  
**Last Re-Assessment: 2023-03-30**

**Area (sqft): 0**

ASBESTOS																
System	Component	Material	Item	Covering	A*	V*	AP*	Good	Fair	Poor	Unit	Sample	Asbestos Type	Amount	Hazard	Friable
Ceiling		Plaster			A	Y		100			%	S0002E	None Detected	N.D.	None	
Floor		Terrazzo			A	Y		100			%					
Structure	Not Accessible	no access above solid ceiling			D	N										
Wall		Masonry			A	Y		100			%	V0000	Non-Asbestos		None	

**Client: Hamilton-Wentworth Catholic District Sch**  
**Location: #2013 : Classroom 11**  
**Survey Date: 2018-07-13**

**Site: Elementary**  
**Floor: 2**

**Building Name: St. Michael**  
**Room #:**  
**Last Re-Assessment: 2023-03-30**

**Area (sqft): 0**

ASBESTOS																
System	Component	Material	Item	Covering	A*	V*	AP*	Good	Fair	Poor	Unit	Sample	Asbestos Type	Amount	Hazard	Friable
Floor		Laminate, Wood			A	Y										
Floor		Mastic			D	N		100(7)			%	V9500	Presumed Asbestos		Presumed Asbestos	NF
Structure		Concrete (precast)			C	Y		100			%	V0000	Non-Asbestos		None	
Wall		Masonry			A	Y		100			%	V0000	Non-Asbestos		None	

**Client:** Hamilton-Wentworth Catholic District Sch  
**Location:** #2014 : Classroom 10  
**Survey Date:** 2018-07-13

**Site:** Elementary  
**Floor:** 2

**Building Name:** St. Michael  
**Room #:**  
**Last Re-Assessment:** 2023-03-30

**Area (sqft):** 0

ASBESTOS																
System	Component	Material	Item	Covering	A*	V*	AP*	Good	Fair	Poor	Unit	Sample	Asbestos Type	Amount	Hazard	Friable
Floor		Laminate, Wood			A	Y										
Floor		Mastic			D	N		100(7)			%	V9500	Presumed Asbestos		Presumed Asbestos	NF
Floor <sup>1</sup>		Vinyl Floor Tile (No Mastic)			A	Y		100			%	V9500	[None]		[Abated]	
Structure		Concrete (precast)			A	Y		100			%	V0000	Non-Asbestos		None	
Wall		Masonry			A	Y		100			%	V0000	Non-Asbestos		None	

1 - 12x12 aqua dense fleck

**Client:** Hamilton-Wentworth Catholic District Sch  
**Location:** #2015 : Storage  
**Survey Date:** 2018-07-13

**Site:** Elementary  
**Floor:** 2

**Building Name:** St. Michael  
**Room #:**  
**Last Re-Assessment:** 2023-03-30

**Area (sqft):** 0

ASBESTOS																
System	Component	Material	Item	Covering	A*	V*	AP*	Good	Fair	Poor	Unit	Sample	Asbestos Type	Amount	Hazard	Friable
Ceiling		Ceiling Tiles (lay-in), Long			C	Y		100			%	V0000	Non-Asbestos		None	
Floor		Vinyl Floor Tile and Mastic, 12x12 tan with brown streaks			A	Y		100(7)			%	V9500	Presumed Asbestos		Presumed Asbestos	NF
Floor		Rubber			A	Y										
Wall		Masonry			A	Y		100			%	V0000	Non-Asbestos		None	

**Client:** Hamilton-Wentworth Catholic District Sch  
**Location:** #2016 : Storage Sink Room  
**Survey Date:** 2018-07-13

**Site:** Elementary  
**Floor:** 2

**Building Name:** St. Michael  
**Room #:**  
**Last Re-Assessment:** 2023-03-30

**Area (sqft):** 0

ASBESTOS																
System	Component	Material	Item	Covering	A*	V*	AP*	Good	Fair	Poor	Unit	Sample	Asbestos Type	Amount	Hazard	Friable
Ceiling		Plaster			C	Y		100			%	V0002	None Detected	N.D.	None	
Floor		Terrazzo			A	Y		100			%					
Wall		Masonry			A	Y		100			%	V0000	Non-Asbestos		None	

**Client:** Hamilton-Wentworth Catholic District Sch  
**Location:** #2017 : Washroom  
**Survey Date:** 2018-07-13

**Site:** Elementary  
**Floor:** 2

**Building Name:** St. Michael  
**Room #:**  
**Last Re-Assessment:** 2023-03-30

**Area (sqft):** 0

ASBESTOS																
System	Component	Material	Item	Covering	A*	V*	AP*	Good	Fair	Poor	Unit	Sample	Asbestos Type	Amount	Hazard	Friable
Ceiling		Plaster			C	Y		100			%	V0002	None Detected	N.D.	None	
Floor		Terrazzo			A	Y		100			%					
Wall		Masonry			A	Y		100			%	V0000	Non-Asbestos		None	

**Client:** Hamilton-Wentworth Catholic District Sch  
**Location:** #2018 : Classroom 8  
**Survey Date:** 2018-07-13

**Site:** Elementary  
**Floor:** 2

**Building Name:** St. Michael  
**Room #:**  
**Last Re-Assessment:** 2023-03-30

**Area (sqft):** 0

ASBESTOS																
System	Component	Material	Item	Covering	A*	V*	AP*	Good	Fair	Poor	Unit	Sample	Asbestos Type	Amount	Hazard	Friable
Floor <sup>1</sup>		Vinyl Floor Tile and Mastic, 12x12 mint with grey fleck			A	Y		100(7)			%	V9500	Presumed Asbestos		Presumed Asbestos	NF
Floor <sup>2</sup>		Vinyl Floor Tile and Mastic, 12x12 pink dense fleck			A	Y		100(7)			%	V9500	Presumed Asbestos		Presumed Asbestos	NF
Structure		Concrete (precast)			C	Y		100			%	V0000	Non-Asbestos		None	
Wall		Masonry			A	Y		100			%	V0000	Non-Asbestos		None	

1 - 12x12 mint with grey fleck

2 - 12x12 mint with grey fleck

**Client:** Hamilton-Wentworth Catholic District Sch  
**Location:** #2019 : Classroom 9  
**Survey Date:** 2018-07-13

**Site:** Elementary  
**Floor:** 2

**Building Name:** St. Michael  
**Room #:**  
**Last Re-Assessment:** 2023-03-30

**Area (sqft):** 0

ASBESTOS																
System	Component	Material	Item	Covering	A*	V*	AP*	Good	Fair	Poor	Unit	Sample	Asbestos Type	Amount	Hazard	Friable
Ceiling		Masonry			A	Y		100			%	V0000	Non-Asbestos		None	
Floor		Vinyl Floor Tile and Mastic, 12x12 beige with yellow flecks			A	Y		100(7)			%	V9500	Presumed Asbestos		Presumed Asbestos	NF
Floor		Vinyl Floor Tile and Mastic, 12x12 salmon with white flecks			A	Y		100(7)			%	V9500	Presumed Asbestos		Presumed Asbestos	NF
Floor <sup>1</sup>		Vinyl Sheet Flooring, Off-white with dark flecks			A	Y		10(7)			SF	V9500	Presumed Asbestos		Presumed Asbestos	PF
Floor		Carpet			A	Y		100			%	V0000	Non-Asbestos		None	
Other																
Wall		Masonry			A	Y		100			%	V0000	Non-Asbestos		None	

1 - On low shelf/platform

**Client:** Hamilton-Wentworth Catholic District Sch  
**Location:** #2020 : Stairwell  
**Survey Date:** 2018-07-13

**Site:** Elementary  
**Floor:** 2

**Building Name:** St. Michael  
**Room #:**  
**Last Re-Assessment:** 2023-03-30

**Area (sqft):** 0

**ASBESTOS**

System	Component	Material	Item	Covering	A*	V*	AP*	Good	Fair	Poor	Unit	Sample	Asbestos Type	Amount	Hazard	Friable
Floor		Terrazzo			A	Y						V0013	Chrysotile	<0.5%	None	
Structure		Concrete (precast)			C	Y		100			%	V0000	Non-Asbestos		None	
Wall		Masonry			A	Y		100			%	V0000	Non-Asbestos		None	

**Client:** Hamilton-Wentworth Catholic District Sch  
**Location:** #2021 : Girl's Washroom  
**Survey Date:** 2018-07-13

**Site:** Elementary  
**Floor:** 2

**Building Name:** St. Michael  
**Room #:**  
**Last Re-Assessment:** 2023-03-30

**Area (sqft):** 0

**ASBESTOS**

System	Component	Material	Item	Covering	A*	V*	AP*	Good	Fair	Poor	Unit	Sample	Asbestos Type	Amount	Hazard	Friable
Ceiling		Plaster			C	Y		100			%	V0002	None Detected	N.D.	None	
Floor		Terrazzo			A	Y		100			%					
Structure	Not Accessible	no access above solid ceiling			D	N										
Wall		Masonry			A	Y		100			%	V0000	Non-Asbestos		None	



**Client:** Hamilton-Wentworth Catholic District Sch  
**Location:** #2022 : Storage  
**Survey Date:** 2018-07-13

**Site:** Elementary  
**Floor:** 2

**Building Name:** St. Michael  
**Room #:**  
**Last Re-Assessment:** 2023-03-30

**Area (sqft):** 0

ASBESTOS																
System	Component	Material	Item	Covering	A*	V*	AP*	Good	Fair	Poor	Unit	Sample	Asbestos Type	Amount	Hazard	Friable
Floor		Vinyl Floor Tile and Mastic, 12x12 salmon with brown streaks			A	Y		100(7)			%	V9500	Presumed Asbestos		Presumed Asbestos	NF
Structure		Concrete (precast)			C	Y		100			%	V0000	Non-Asbestos		None	
Wall		Masonry			A	Y		100			%	V0000	Non-Asbestos		None	

## Legend:



Sample number		Units		Other	
S####	Asbestos sample collected	SF	Square feet	A	Access
V####	Material visually similar to numbered sample collected	LF	Linear feet	V	Visible
V0000	Known non-asbestos material	EA	Each	AP	Air Plenum
V9000	Visually identified as an asbestos material	%	Percentage	F	Friable material
V9500	Material is presumed to be an asbestos material			NF	Non Friable material
				PF	Potentially Friable material

Access	
A	Accessible to all building occupants
B	Accessible to maintenance and operations staff without a ladder
C	Accessible to maintenance and operations staff with a ladder. Also rarely entered, locked areas
D	Not normally accessible

Condition	
Good	No visible damage or deterioration
Fair	Minor, repairable damage, cracking, delamination or deterioration
Poor	Irreparable damage or deterioration with exposed and missing material

Visible	
Y	The material is visible when standing on the floor of the room, without the removal or opening of other building components (e.g. ceiling tiles or access panels).
N	The material is not visible to view when standing on the floor of the room and requires the removal of a building component (e.g. ceilings tiles or access panels) to view and access. Includes rarely entered crawlspaces, attic spaces, etc. Observations will be limited to the extent visible from the access points.

Air Plenum	
Yes or No	The material is in a return air plenum or in a direct airstream or there is evidence of air erosion (e.g. duct for heating or cooling blowing directly on or across an ACM). This field is only completed where Air Plenum consideration is required by regulation.

Colour Coding	
	The material is known to contain regulated concentrations of asbestos; either by analytical results or visible identification (use of the V9000 code).
	The material is presumed to contain asbestos; based on visual appearances; typically a material known to historically contain asbestos; however, not sampled due to limited access or the destructive nature of the sampling.

Action					
(1)	Clean up of ACM Debris	(2)	Precautions for Access Which may Disturb ACM Debris	(3)	ACM removal
(4)	Precautions for Work Which may Disturb ACM in Poor Condition	(5)	Proactive ACM removal (Minimum repair required for fair condition)	(6)	ACM repair
(7)	Management program and surveillance				

**APPENDIX V**  
**Drawings**

NOT ALL KNOWN OR SUSPECTED ASBESTOS BUILDING MATERIALS MAY BE DEPICTED ON THE DRAWING. REFER TO THE ASBESTOS REASSESSMENT REPORT FOR A COMPLETE LIST OF KNOWN AND SUSPECTED ASBESTOS BUILDING MATERIALS.

LEGEND IS COLOUR DEPENDENT. NON-COLOUR COPIES MAY ALTER INTERPRETATION.

BASE PLAN PROVIDED BY CLIENT.

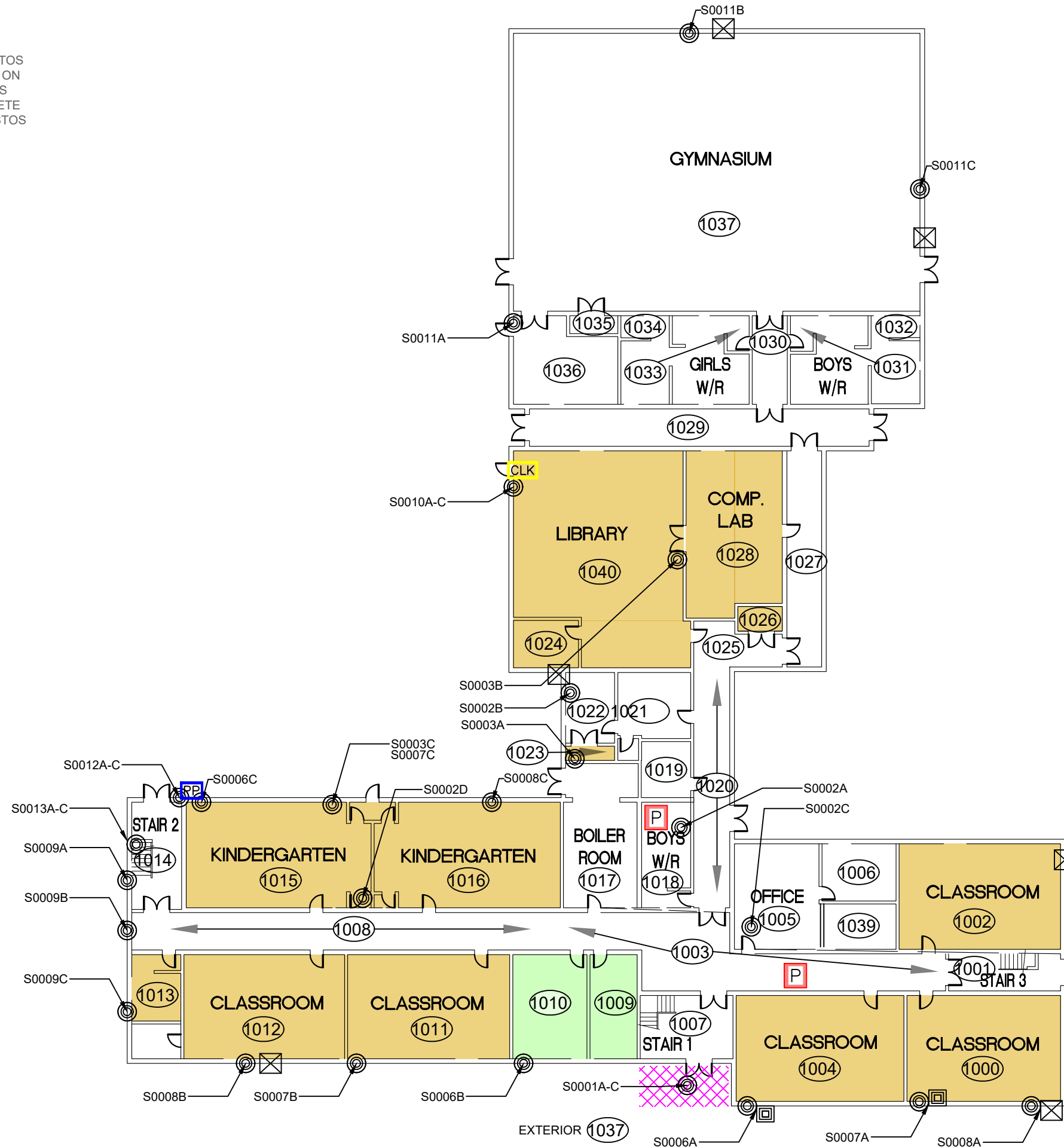

905-577-6206 www.pinchin.com

- LEGEND:**
- (X) LOCATION NUMBER
  - ⊙ ASBESTOS BULK SAMPLE
- ASBESTOS-CONTAINING MATERIALS:**
- P PIPE INSULATION
  - VINYL SHEET FLOORING
  - VINYL FLOOR TILES & MASTIC
  - MASTIC
  - PLASTER SOFFIT
  - X LOCATION OF VERMICULITE DRILLING
  - CLK CAULKING
  - PP PIPE PACKING

**CLIENT:**



Hamilton-Wentworth  
Catholic District School Board  
*Believing, Achieving, Serving*

**LOCATION:**

ST. MICHAEL  
135 HESTER STREET  
HAMILTON, ONTARIO

**TITLE:**

ASBESTOS REASSESSMENT  
FLOOR LEVEL 1

<b>DATE:</b> MAY 2023	<b>PROJECT #:</b> 320582.001
<b>DRAWN BY:</b> NM	<b>DRAWING:</b>  1 OF 2
<b>CHECKED BY:</b> EB	
<b>SCALE:</b> NTS	



905-577-6206 www.pinchin.com

LEGEND:

- (X) LOCATION NUMBER
- ⊙ ASBESTOS BULK SAMPLE

ASBESTOS-CONTAINING MATERIALS:

- P PIPE INSULATION
- VINYL SHEET FLOORING
- VINYL FLOOR TILES & MASTIC
- MASTIC
- PLASTER SOFFIT
- LOCATION OF VERMICULITE DRILLING
- CLK CAULKING
- PP PIPE PACKING

CLIENT:



LOCATION:

ST. MICHAEL  
135 HESTER STREET  
HAMILTON, ONTARIO

TITLE:

ASBESTOS REASSESSMENT  
FLOOR LEVEL 2

DATE:

MAY 2023

PROJECT # :

320582.001

DRAWN BY:

NM

DRAWING:

2 OF 2

CHECKED BY:

EB

SCALE:

NTS

NOT ALL KNOWN OR SUSPECTED ASBESTOS BUILDING MATERIALS MAY BE DEPICTED ON THE DRAWING. REFER TO THE ASBESTOS REASSESSMENT REPORT FOR A COMPLETE LIST OF KNOWN AND SUSPECTED ASBESTOS BUILDING MATERIALS.

LEGEND IS COLOUR DEPENDENT. NON-COLOUR COPIES MAY ALTER INTERPRETATION.

BASE PLAN PROVIDED BY CLIENT.

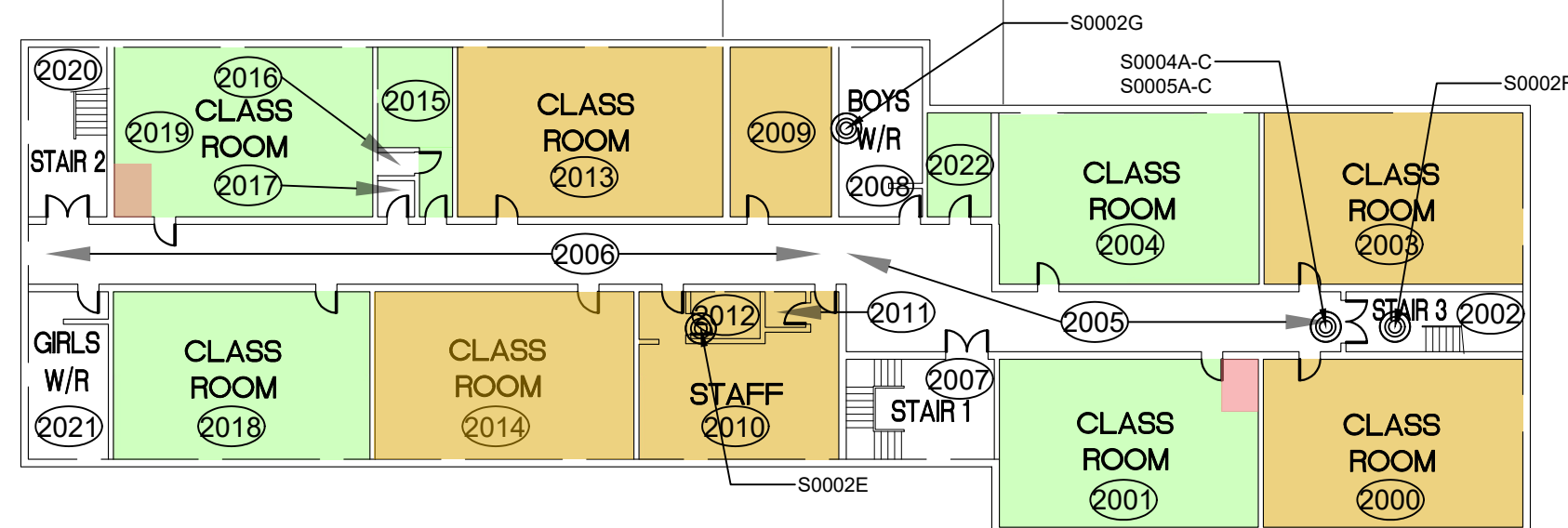

**APPENDIX VI**  
**Methodology**



## **1.0 GENERAL**

Pinchin conducted an inspection of previously identified asbestos-containing materials (ACM) to evaluate the current condition of all accessible ACM identified in the most recent assessment.

The surveyor made reference to any existing assessment or abatement reports (as provided by the Client).

Materials listed as exclusions in the previous reports have remained as exclusions. Sampling, assessment or verification of excluded materials was not conducted.

Existing sampling data, where available, was reviewed and relied upon.

Where sampling was conducted, sample collection was conducted in accordance with our Standard Operating Procedures.

A separate set of samples was collected of each type of homogenous material suspected to contain asbestos. A homogenous material is defined by the US EPA as material that is uniform in texture and appearance, was installed at one time, and is unlikely to consist of more than one type or formulation of material. The homogeneous materials were determined by visual examination and available information on the phases of construction and prior renovations.

Samples were collected at a rate that is in compliance with the requirements of local regulations and guidelines. The sampling strategy was also based on known ban dates and phase out dates of the use of asbestos; sampling of certain building materials is not conducted after specific construction dates. In addition, to be conservative, several years past these dates are added to account for some uncertainty in the exact start / finish date of construction and associated usage of ACM. In some cases, manufactured products such as asbestos cement pipe were visually identified without sample confirmation.

The asbestos analysis was completed using a stop-positive approach. Only one result meeting the regulated criteria was required to determine that a material is asbestos-containing, but all samples must be analyzed to conclusively determine that a material is non-asbestos. The laboratory stopped analyzing samples from a homogeneous material once a result equal to or greater than the regulated criteria is detected in any of the samples of that material. All samples of a homogeneous material were analyzed if no asbestos is detected. In some cases, all samples were analyzed in the sample set regardless of result.

The analysis was performed in accordance with Test Method EPA/600/R-93/116: Method for the Determination of Asbestos in Bulk Building Materials, July 1993.

The following summarizes the criteria of asbestos definitions.



<b>Jurisdiction</b>	<b>Friable</b>	<b>Non-Friable</b>
Ontario	0.5%	0.5%

Where building materials are described in the report as “non-asbestos” or “does not contain asbestos”, this means that either no asbestos was detected by the analytical method utilized in any of the multiple samples or, if detected, it is below the lower limit of an asbestos-containing material in the applicable regulation. Additionally, these terms are used for materials which historically are known to not include asbestos in their manufacturing.

Asbestos materials are evaluated in order to make recommendations regarding remedial work. The priority for remedial action is based on several factors:

- Friability (friable or non-friable).
- Condition (good, fair, poor, debris).
- Accessibility (ranking from accessible to all building users to inaccessible).
- Visibility (whether the material is obscured by other building components).
- Efficiency of the work (for example, if damaged ACM is being removed in an area, it may be most practical to remove all ACM in the area even if it is in good condition).

For a complete description of the Evaluation Criteria and Basis of Recommendations, refer to Annex A.

Template: Methodology for Asbestos Reassessment, HAZ, July 27, 2021



## **METHODOLOGY ANNEX A EVALUATION CRITERIA**

## 1.0 EVALUATION CRITERIA AND BASIS OF RECOMMENDATIONS

The detailed asbestos assessment provides information regarding the location, condition, accessibility and friability of the asbestos-containing materials (ACM). In order to make recommendations for compliance with current regulations, Pinchin developed the following criteria.

## 2.0 EVALUATION OF CONDITION

### 2.1 Friable Sprayed or Trowelled Fireproofing, Thermal Insulation and Texture Finishes (Surfacing Materials)

To evaluate the condition of ACM sprayed or trowelled on fireproofing, sprayed or trowelled thermal insulation (non-mechanical), or texture, decorative or acoustic finishes, the following criteria are applied:

<b>Good</b>	Surface of material shows no significant signs of damage, deterioration or delamination. Good condition includes unencapsulated or unpainted fireproofing or texture finishes, where no or limited delamination or damage is observed, or encapsulated fireproofing or texture finishes where the encapsulant or paint has been applied after the damage or fallout occurred.
<b>Poor</b>	A sprayed material that shows signs of significant damage or is significantly delaminating or deteriorating. This may be limited to surface delamination or some portion of the substrate may be exposed.

In Locations where damage exists in isolated areas, both good and poor condition may be applicable. The extent of each condition will be recorded. Fair condition is not utilized in the evaluation of ACM sprayed or trowelled fireproofing, sprayed or trowelled thermal insulation (non-mechanical), or texture, decorative or acoustic finishes.

The evaluation of the above products above ceilings may be limited by the number of observations and by building components such as ducts or full height walls that obstruct the above ceiling observations.

### 2.2 Friable Mechanical or Thermal System Insulation (TSI)

To evaluate the condition of mechanical insulation on vessels, boilers, breeching, ducts, pipes, fan units, equipment etc. the following criteria are applied:

<b>Good</b>	Insulation is completely covered in jacketing and exhibits no evidence of damage or deterioration. No insulation is exposed. Includes conditions where the jacketing has minor damage (i.e. scuffs or stains), but the jacketing is not penetrated.
<b>Fair</b>	Minor penetrating damage to jacketed insulation (cuts, tears, nicks, deterioration or delamination) or undamaged insulation that has never been jacketed. Insulation is exposed but not showing surface disintegration. The extent of missing insulation ranges from minor to none. Damage can be repaired.

---

<b>Poor</b>	Original insulation jacket is missing, damaged, deteriorated or delaminated. Insulation is exposed and significant areas have been dislodged. Damage cannot be readily repaired. Includes components where insulation may have been removed incompletely.
-------------	---

---

The evaluation of mechanical insulation may be limited by the number of observations made and building components such as ducts or full height walls that obstruct observations. It is often not possible to observe each foot of mechanical insulation from all angles.

### 2.3 Potentially Friable Materials and Miscellaneous Friable Materials

Potentially friable ACM are products that are basically non-friable while in place but have the potential to generate friable dust upon removal or if significantly disturbed without appropriate procedures. These products may become friable if damaged. Potentially friable materials include materials such as acoustic ceiling tiles and plaster. To evaluate the condition of potentially friable materials, the following criteria are applied:

---

<b>Good</b>	No significant damage or deterioration. Still serving its intended use as a building material or finish.
<b>Fair</b>	Showing signs of some cracking or breakage, but is not deteriorating (e.g. cracked plaster, broken but in place ceiling tile, missing tile or section of plaster etc.). The condition is such that it is still serving its intended use as a building material or finish but may require repair for mainly cosmetic purposes.
<b>Poor</b>	Significant deterioration or breaking apart of the material. Material has deteriorated to the point it is not serving its intended use as building material or finish. Material has deteriorated to a point it has become friable. Normally potentially friable ACM in Poor condition is not repairable and requires at least localized removal and replacement.

---

### 2.4 Non-Friable Materials

Non-friable ACM cover a wide range of products with a wide variation in their tendency to release dust or asbestos fibres to the air. Many of these materials, (particularly where the matrix is an unweathered bitumen, asphalt or tar material) do not release fibres except in very unusual circumstances or during significant disturbance (e.g. use of abrasive power tools). Others with a cementitious matrix (asbestos-cement products) can more readily release dust due to abrasion, demolition, weathering, etc. The potential for asbestos release from non-friable ACM is always lower than from friable ACM. To evaluate the condition of non-friable Materials, the following criteria are applied:

---

<b>Good</b>	No significant damage or deterioration. Still serving its intended use as a building material or finish.
-------------	--

---

---

<b>Fair</b>	Showing signs of some cracking or breakage but is not deteriorating (e.g. cracked vinyl floor tile, missing piece of tile or transite, etc.). The condition is such that it is still serving its intended use as a building material or finish but may require repair for mainly cosmetic purposes.
<b>Poor</b>	Significant deterioration or breaking apart of the material to the point at which it cannot be repaired, and it will require at least local removal. Material has deteriorated to the point it is not serving its intended use as building material or finish. Material may have deteriorated to a point where traffic or disturbance may cause it to become friable.

---

## 2.5 Evaluation of ACM Debris

The identification of the exact location or presence of debris on the top of ceiling tiles is limited by the number of observations made and the presence of building components such as ducts or full height walls that obstruct observations.

The presence of fallen or dislodged ACM is noted separately from the ACM source and is referred to as Debris. Debris may be friable if from a friable ACM source or a badly deteriorated non-friable ACM source. Debris may also be non-friable (such as fallen pieces of transite sheet or mastic fittings, or broken, dislodged floor tiles).

---

<b>Debris</b>	Debris may be friable or non-friable but is always identified as debris.
---------------	--

---

## 2.6 Evaluation of Presumed Asbestos-Containing Material (PACM)

Presumed asbestos-containing materials (PACM), are building materials that may contain asbestos but were not sampled or analyzed due to inaccessibility or the need to perform destructive testing to obtain a reasonable sample set. Evaluation of these materials is based on the assumption that these PACM are asbestos-containing.

A list of PACM is provided in the report and they are generally not included in the detailed room by room reports. Typically, they are excluded because they are inaccessible or present in very small quantities. If PACM are evaluated, Pinchin uses the criteria that correspond with the type (and friability) of the material listed above.

### 3.0 EVALUATION OF ACCESSIBILITY

The accessibility of building materials known or suspected of being ACM is rated according to the following criteria:

<b>Access (A)</b>	Common areas of the building within reach of all building users (approximately 8' - 9' from floor or standard ceiling height). Includes other areas where occupant activities may result in disturbance of material that is not normally within reach from floor level, but may be disturbed by common activities (e.g. gymnasiums, workshops)
<b>Access (B)</b>	Areas of the building accessed primarily by Maintenance/Caretaking/Janitorial Staff and within reach without use of a ladder. Includes areas within reach in Boiler Rooms, Electrical Rooms, Janitors Closets, Elevator Rooms, Mechanical Rooms, etc. Includes materials within reach from fixed ladders or catwalks, mezzanines, and accessible pipe chases.
<b>Access (C) and Visible</b>	Areas of the building above 8' - 9' where use of a ladder or scaffold is required to reach the ACM. Only includes ACM that are visible to view without the removal or opening of other building components such as ceiling tiles or service access panels. Visible column on HMIS sheets will say YES.
<b>Access (C) and not Visible</b>	Areas of the building above 8' - 9' where use of a ladder or scaffold is required to reach the ACM. Includes ACM that are not visible to view and require the removal of a building component to see, such as ceilings tiles or access panels to view and access. Includes rarely entered crawl spaces, attic spaces, etc. Observations will be limited to the extent visible from the access points. Visible column on HMIS sheets will say NO.
<b>Access (D)</b>	Areas of the building behind inaccessible solid ceiling systems, walls or equipment etc. where demolition of the ceiling, wall or equipment etc. is required to reach the ACM. Material inaccessible due to height or location or is only accessed under unusual situations. Evaluation of condition and extent of ACM is limited or impossible, depending on the surveyor's ability to visually examine materials in Access D.

### 4.0 ACTION MATRIX AND DEFINITIONS

Pinchin's evaluation of the viability of a specific asbestos control option is based on the consideration of the friability, condition, accessibility and visibility of a material. The logic used is that damaged ACM located in an area frequently accessed by all building occupants is of a higher priority than damaged ACM located in an infrequently accessed service area. The action matrix considers the potential for fibre release (primarily from friable ACM) and the possible concerns from regulatory bodies and many building occupants to all damaged ACM (including non-friable).

In any building with asbestos, many current regulations require an Asbestos Management Program be implemented. Depending on the condition and the accessibility, more active measures such as repair or removal may be recommended. The following matrix provides guidance for recommended Actions in the absence of renovation or demolition. In the event of construction or maintenance activity which will disturb ACM more aggressive control or removal will be required.

#### 4.1 Action Matrix

The following tables outline the action decisions based on the relationship of assessed factors. Table I applies to friable ACM. Table II applies to non-friable ACM.

**Table I Decision Matrix for Friable ACM**

Access	Condition			Debris
	Good	Fair	Poor	
(A)	Action 5 <sup>1</sup>	Action 5 <sup>2</sup>	Action 3	Action 1
(B)	Action 7	Action 6 <sup>3</sup>	Action 3	Action 1
(C) Visible	Action 7	Action 6	Action 3	Action 2
(C) Not Visible	Action 7	Action 7	Action 4	Action 2
(D)	Action 7	Action 7	Action 7	Action 7

**Table II Decision Matrix for Potentially Friable and Non-Friable ACM**

Access	Condition			Debris
	Good	Fair	Poor	
(A)	Action 7	Action 7 <sup>4</sup>	Action 3	Action 1
(B)	Action 7	Action 7	Action 3	Action 1
(C) Visible	Action 7	Action 7	Action 4	Action 2
(C) Not Visible	Action 7	Action 7	Action 4	Action 2
(D)	Action 7	Action 7	Action 7	Action 7

#### 4.2 Action Definitions

The following are the definitions in the Action Matrix Table presented above:

##### Action Definitions

<b>Action 1</b>	Clean-Up of ACM Debris Restrict access that is likely to cause a disturbance of the ACM Debris and clean up ACM Debris. Utilize appropriate asbestos precautions.
-----------------	--

<sup>1</sup> If friable ACM in access (A)/Good condition is not proactively removed Action 7 (Manage) is recommended.

<sup>2</sup> If friable ACM in access (A)/Fair condition is not proactively removed repair is recommended.

<sup>3</sup> If friable ACM in access (B)/Fair condition is likely to be disturbed after repair proactive removal is recommended.

<sup>4</sup> Action 7 is recommended for all non-friable ACM in Fair condition however some clients may wish to repair or take some action primarily for cosmetic reasons



---

### Action Definitions

---

<b>Action 2</b>	<p>Precautions for Access Which may Disturb ACM Debris</p> <p>Use appropriate means to isolate the debris or to limit entry to the area which may disturb the material. At locations where ACM Debris can remain in place in lieu of removal or clean-up (e.g. Debris on top of ceiling tiles or behind lockable door), Utilize appropriate asbestos precautions to enter the area if this will disturb debris. The precautions will be required until the ACM Debris has been cleaned up.</p>
<b>Action 3</b>	<p>ACM Removal</p> <p>Remove ACM. Utilize asbestos procedures appropriate to the scope of the removal work. Until it is removed, restrict access to the material so it is not disturbed.</p>
<b>Action 4</b>	<p>Precautions for Work Which may Disturb ACM in Poor Condition. Utilize appropriate asbestos precautions if ACM may be disturbed by work on or near ACM. This does not require restricting access to the area, only control of work which may contact or disturb the ACM. Removal is the only viable option if work will disturb ACM.</p>
<b>Action 5</b>	<p>Proactive ACM Removal</p> <p>Remove friable ACM where the presence of friable asbestos in Good condition is not desirable. If friable ACM in Fair condition is not removed, then Repair friable ACM.</p>
<b>Action 6</b>	<p>ACM Repair</p> <p>Repair friable ACM in Fair condition which is not likely to be damaged again or disturbed by normal use of the area or room. Pinchin recommends proactive removal if friable ACM is likely to be damaged or disturbed during normal use of the area or room</p>
<b>Action 7</b>	<p>Asbestos Management Program with Routine Surveillance Implement an Asbestos Management Program, including routine surveillance of ACM. Reassess materials regularly (typically once per year).</p>

---

Master Template: Methodology Annex A to Appendix I Evaluation Criteria, HAZ, January 10, 2020